

**PHILIPS  
ADVANCE**

**Metal  
Halide  
Lamp Ballast**

**Catalog Number 79W5590  
For 175W M57  
60 Hz CWA  
Status: Active**

**DIMENSIONS AND DATA**

79W  
OUTDOOR  
WEATHERPROOF  
DIMENSIONS

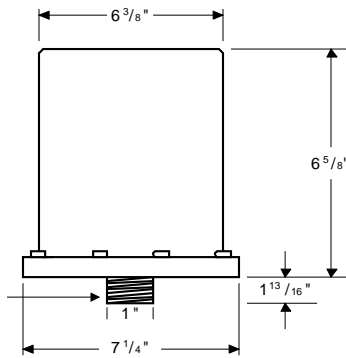

INPUT VOLTS		120	208	240	277
CIRCUIT TYPE	CWA				
POWER FACTOR (min)	90%				
REGULATION					
Line Volts	±10%				
Lamp Watts	±10%				
LINE CURRENT (Amps)					
Operating.....		1.80	1.04	0.90	0.80
Open Circuit.....		1.80	1.04	0.90	0.80
Starting.....		1.30	0.75	0.65	0.55
UL TEMPERATURE RATINGS					
Insulation Class	H(180°C)				
Coil Temperature Code	1029				
MIN. AMBIENT STARTING TEMP.	-20°F or -30°C				
NOM. OPEN CIRCUIT VOLTAGE	305				
INPUT VOLTAGE AT LAMP DROPOUT.....		60	104	120	138
INPUT WATTS	210				
RECOMMENDED FUSE (Amps).....		5	3	3	2
CORE and COIL					
Dimension (A)					
Dimension (B)	15				
Weight (lbs.)	10"				
Lead Lengths					
CAPACITOR REQUIREMENT					
Microfarads					
Volts (min.)					
Fault Current Withstand (amps)					
60 Hz TEST PROCEDURES (Refer to Philips Lighting Electronics N.A. TEST Procedure for HID Ballasts - Form High Potential Test (Volts)					
	2000				
1 minute	2500				
2 seconds	275-335				
Open Circuit Voltage Test (Volts)					
Short-Circuit Current Test (Amps)	1.50-1.90				
Secondary Current					
Input Current.....		0.85	0.45	0.40	0.30
		1.25	0.70	0.60	0.50

Capacitor:

The capacitor is included as part of the potted assembly.

Ignitor: NA

This ballast does not require the use of an ignitor.

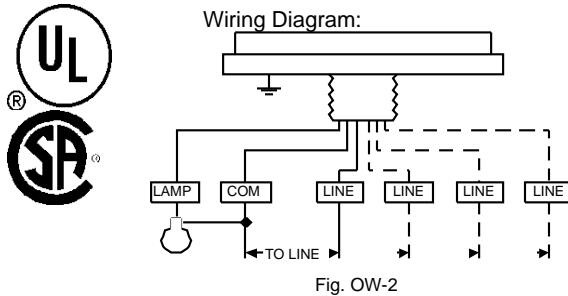

**Typical Ordering Information**

(please call Philips Lighting Electronics N.A. for suffix availability)

Order Suffix	Description
--------------	-------------

Data is based upon tests performed by Philips Lighting Electronics N.A. in a controlled environment and is representative of relative performance. Actual performance can vary depending on operating conditions. Specifications are subject to change without notice.

**PHILIPS LIGHTING ELECTRONICS N.A.**

10275 WEST HIGGINS ROAD · ROSEMONT, IL 60018

Tel: 800-322-2086 · Fax: 888-423-1882 · www.philips.com/advance

Customer Support/Technical Service: 800-372-3331 · OEM Support: 866-915-5886

Revised: 04/14/00