

## DESCRIPTION

Circadian LED nightlights and chart lights bring soft, low level illumination to any environment. Fitting into a standard junction box (single-gang, handy box, 2" minimum inside width) for easy installation, the MSN, MHN and MLN operate on 120-277V, delivering up to 30 lumens of illumination. The MCL Chart Light has an illuminated push-button switch that can be used without disturbing the patient (120V only), ideal for use in areas such as patient rooms, exam rooms, and nurse stations.

## SPECIFICATION FEATURES

### Mounting / Installation

Fits into standard junction box for easy installation (single-gang, handy box, 2" minimum inside width).

### Faceplate

Unique faceplate design distributes light evenly. Die-cast aluminum louvered or scoop faceplates. White painted faceplate standard; black and brushed nickel paint options available.

### Lens

MSN/MLN/MHN: 4 lenses accompany each unit and are quickly and easily field-installable. Lenses are 0.040" thick polycarbonate, and are clear, amber, red, and blue colors. Install the lens choice based on the desired color of illumination. MCL: Clear acrylic lens, 0.040" thick.

### Wattage

<5 input watts.

### Labels

- MLN, MHN: Wet location listed.
- MSN: Wet location listed above 4' mounting height.
- MCL: Dry location listed.

### MLN

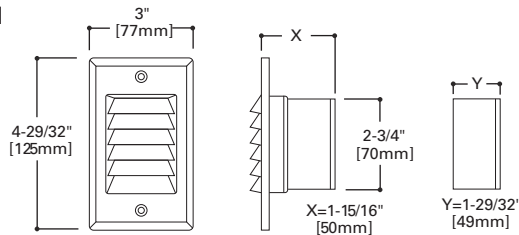

### MHN

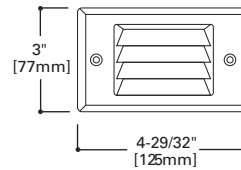

### MCL

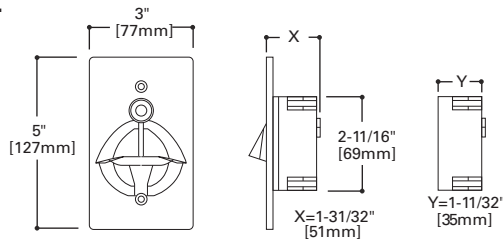

### MSN

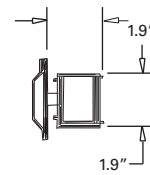
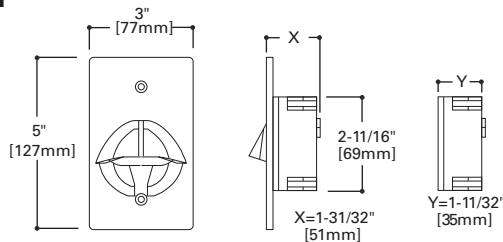

For retrofit applications, check width, height and depth of existing junction box. Requires 2" minimum inside width.



MLN / MHN (120 - 277V)  
(MHN not shown - see line drawing)

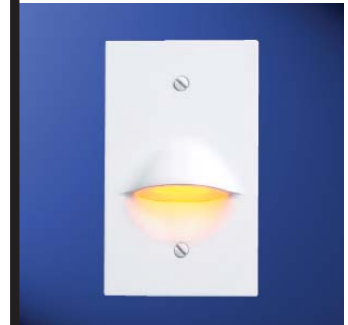

MSN (120 - 277V)

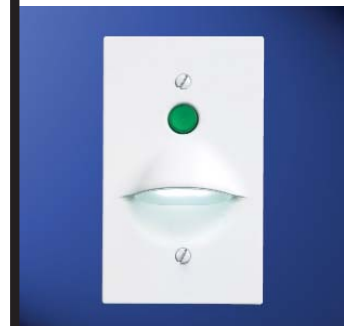

MCL (120V only)

## Circadian UNV

LED  
Healthcare: Patient



## SPECIFICATIONS

	MLN / MHN	MCL / MSN
<b>Illumination</b>	Minimum 30 Lumens	Minimum 30 Lumens
<b>Input Wattage</b>	< 5 Watts	< 5 Watts
<b>Face Plate</b>	Die-cast aluminum	Die-cast aluminum
<b>Code Compliance</b>	UL 1598	UL 1598
<b>Input Voltage</b>	120-277V	MSN - 120-277V MCL - 120V Only
<b>Mounting / Installation</b>	Single-gang junction box (2" minimum inside width)	Single-gang junction box (2" minimum inside width)
<b>Labels</b>	ETL listed	ETL listed - MSN, UL listed - MCL

## ORDERING INFORMATION

## UNIVERSAL VOLTAGE: MHN / MLN / MSN

SAMPLE NUMBER: MSN-UNV-W

UNV		
<b>Product Family</b> <b>MHN</b> = Medical Horizontal Louver <sup>1, 2</sup> <b>MLN</b> = Medical Louver Nightlight <sup>1, 2</sup> <b>MSN</b> = Medical Scoop Nightlight <sup>1, 2</sup>	<b>Voltage</b> <b>UNV</b> =120-277V  <b>NOTES:</b> <sup>1</sup> Wet location standard on MLN, MHN and MSN. <sup>2</sup> Product ships standard with white (4000K) LEDs and a clear polycarbonate lens. Colored lenses ship with each fixture, to field-convert the white color to amber, red or blue - by replacing the clear lens with the lens of choice.	<b>Faceplate Finish</b> <b>W</b> =White Paint <b>B</b> =Black Paint <b>BN</b> =Brushed Nickel Paint Custom Colors available (specify or supply sample - consult factory)

## MCL ORDERING INFORMATION

## 120V MCL

SAMPLE NUMBER: MCL-W-120-W

MCL		120		
<b>Product Family</b> <b>MCL</b> = Medical Chart Nightlight	<b>LED Color</b> <b>W</b> =White <b>A</b> =Amber <b>R</b> =Red	<b>Voltage</b> <b>120</b> =120V	<b>Faceplate Finish</b> <b>W</b> =White Paint <b>B</b> =Black Paint <b>BN</b> =Brushed Nickel Paint Custom Colors available (specify or supply sample - consult factory)	<b>Options</b> <b>PHC</b> =Photocell (in place of <sup>1</sup> standard on/off switch)

## NOTES:

<sup>1</sup> The MCL version of Circadian is supplied with a photo optic cell which turns the light source (LED) off when the ambient light rises above the MCL set point or threshold. In a very limited number of applications, where the sustained ambient light is at or near the MCL set point, the user may experience "flickering" of the light. To avoid "flickering", do not install the MCL in areas such as in dark shadows or dark corners. Should flickering occur, relocate the MCL to an area of higher ambient light.