

DESCRIPTION

Corelite's Class A Perf suspended semi-indirect fluorescent luminaire combines classic design with contemporary styling perfect for today's interiors. The engineered optical system provides a widespread upright distribution for excellent ceiling uniformity and wide row spacing. The perforated fixture housing creates a soft downlight component to closely match the ceiling brightness, which minimizes contrast on computer screens. Class A Perf may be mounted individually or continuously with 4', 8' and 12' modular sections. Luminaires align with T-Grid and interface with all ceiling types. Class A Perf is suited for open offices, private offices, conference rooms, corridors, schools, libraries, labs and public spaces.

SPECIFICATION FEATURES

A ... Construction

Housing is one piece die-formed 20-gauge cold rolled steel, forming a 9" x 2 7/8" architectural profile. Perforated sections are 23% open with 0.0625" staggered hole pattern and opal diffuser. Standard 4'-0", 8'-0", and 12'-0" fixture lengths combine for continuous runs.

B ... End Plates

Standard laser cut 14-gauge cold rolled steel, mechanically attached with no exposed fasteners. Optional die-cast aluminum end caps also available.

C ... Reflectors

Reflector pan is painted with a high reflectance white powder coat finish. Optional die-formed side reflectors are highly specular anodized aluminum.

D ... Electrical

Fixtures are prewired with quick wire connectors and use UL listed Class P, 265ma T8 instant start universal voltage electronic ballasts. Power factor of 95% with less than 10% THD. Fixtures and electrical components certified to UL and CUL standards.

E ... Finish

Fixture housings are standard white using electrostatically applied polyester powder coat paint.

Mounting

Standard aircraft cable mounts on 4'-0", 8'-0" and 12'-0" centers. Refer to installation section for various ceiling interface details and rigid pendant mounting details.

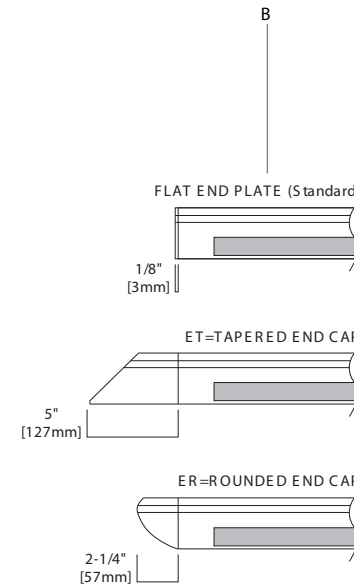
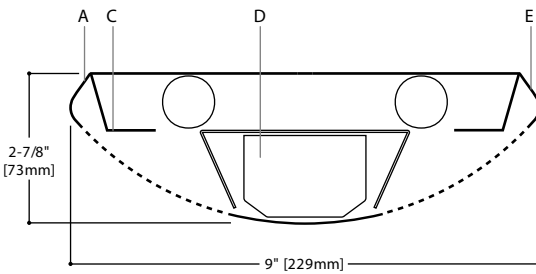
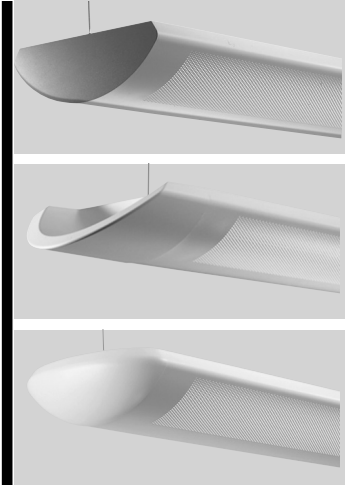

Class A Perf

2T8

Suspended
Semi-Indirect

Light Distribution
Indirect - 94.8%
Direct - 5.2%

MODULES AND DIMENSIONS*

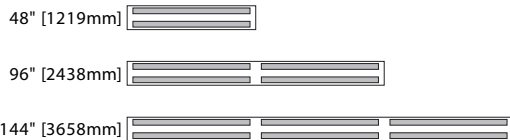

*Dimensions do not include end plates.

ORDERING INFORMATION

Sample Number: AP-WP-2T8-1C-UNV-AC48-T1-12-ET



Series AP: Class A Perf Suspended	Number of Lamps 2: 2 Lamps	Wiring 1 B: Battery Pack C: Standard Circuit D: Dimming E: Emergency T: Nightlight Y: Daylight	Voltage 1 120: 120V 277: 277V 347: 347V UNV: Universal (120V-277V)	Suspension Length Fixed Cable 12", 15", 18", 21", 24", or 27" (+/- 1/2" adjustment) Adjustable Cable 48", 120", 240", 300", or 360" (infinite adjustment along entire length of cable) Rigid Pendant 2 12", 15", 18", 21", 24", or 27"	Ceiling Type T1: 1" T-Bar T9: 9/16" T-Bar TS: Slotted T-Bar ST: Structure JB: 4" Octagonal J-Box	Options ER: Rounded End Cap ET: Tapered End Cap
Optics Up S: Specular W: White	Lamp Type T8: T8 Normal Output	Number of Circuits 1 1: 1 Circuit 2: 2 Circuits	Suspension A: Aircraft Cable P: Rigid Pendant	Run Length Individually Mounted Luminaires may be 4', 8', or 12' in length Continuously Mounted Standard row configurations over 12' consist of 8' and 12' sections		

Notes: 1 Not all options available. Please consult your Cooper Lighting Representative for availability. Specifications and dimensions subject to change without notice.
 2 Consult adder section of the price guide for additional standard lengths.

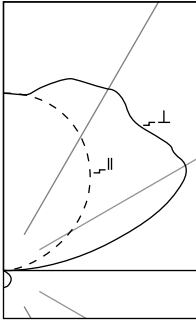

AP-SP-2T8
(2) F32T8/TL841
3000 Lumens

Efficiency 84.6%

Test Report
#ITL46601

Coefficients of Utilization

rc	Effective floor cavity reflectance																		
	80%						70%						20%						
rw	70	50	30	10	70	50	30	10	50	30	10	50	30	10	50	30	10	0	
RCR	0	82	82	82	82	70	70	70	70	49	49	49	30	30	30	13	13	13	00
	1	74	71	68	65	64	61	59	56	43	41	40	26	26	25	11	11	10	00
	2	67	62	57	53	58	53	49	46	38	35	33	23	22	21	10	09	09	00
	3	61	54	48	44	53	47	42	38	33	30	28	20	19	17	09	08	07	00
	4	56	48	42	37	48	41	36	32	29	26	23	18	16	15	08	07	06	00
	5	51	42	36	31	44	37	31	27	26	23	20	16	14	13	07	06	05	00
	6	47	38	31	27	40	33	27	24	23	20	17	14	12	11	06	05	04	00
	7	43	34	27	23	37	29	24	20	21	17	15	13	11	09	06	05	04	00
	8	40	30	24	20	43	26	21	18	19	15	13	12	10	08	05	04	04	00
	9	37	27	22	18	32	24	19	16	17	14	11	11	09	07	05	04	03	00
	10	34	25	19	16	30	22	17	14	16	12	10	10	08	06	04	03	03	00

Candela

Angle	Along II	45°	Across ⊥
180	1066	1066	1066
175	1071	1064	1061
165	1036	1098	1173
155	962	1157	1230
145	854	1118	1235
135	714	1039	1187
125	548	934	1223
115	356	895	1136
105	164	646	668
95	22	178	186
90	1	15	20
85	1	11	18
75	7	18	29
65	15	29	41
55	28	43	52
45	45	56	64
35	63	72	76
25	79	86	88
15	91	96	96
5	98	97	95
0	97	97	97

Zonal Lumen Summary

Zone	Lumens	%Lamp	%Fixture
0-30	75	1.3	1.5
0-40	121	2.0	2.4
0-60	203	3.4	4.0
0-90	263	4.4	5.2
90-120	1587	26.5	31.3
90-130	2423	40.4	47.7
90-150	3882	64.7	76.5
90-180	4812	80.2	94.8
0-180	5075	84.6	100.0

Luminance Data

Angle in Deg	0-Deg cd/sm	45-Deg cd/sm	90-Deg cd/sm
45	260	322	365
55	202	310	368
65	145	275	361
75	110	259	347
85	46	237	300

COMMON CIRCUIT CONFIGURATIONS FOR TWO LAMP SUSPENDED FIXTURE

2C=Two circuit luminaire

2E=Two circuit luminaire with emergency circuit

1B=Single circuit luminaire with battery pack

/1/ =Circuit 1

/2/ =Circuit 2

/E/ =Emergency Circuit

/B/ =Battery Circuit

=Power Mount

=Non-Power Mount

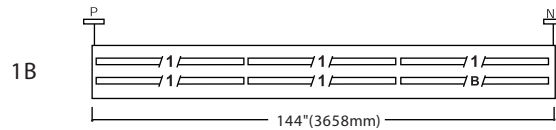
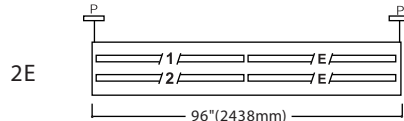
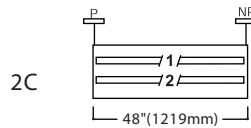

STANDARD ROW CONFIGURATIONS

FIXTURE LENGTH	4'	8'	12'	16'	20'	24'	28'	32'	36'	40'	44'	48'	52'	56'	60'	64'	68'	72'	76'	80'	84'	88'	92'	96'	100'	104'	108'		
4'	1																												
8'		1		2	1		2	1		2	1		2	1		2	1		2	1		2	1		2	1		2	1
12'			1		1	2	1	2	3	2	3	4	3	4	5	4	5	6	5	6	7	6	7	8	7	8	9		