

DESCRIPTION

Corelite's Iridium Perf suspended semi-indirect fluorescent luminaire features elegant styling with sleek profile and end caps. The engineered optical system provides a widespread upright distribution for excellent ceiling uniformity and wide row spacing. The perforated fixture housing creates a soft downlight component to closely match the ceiling brightness, which minimizes contrast on computer screens. Iridium may be mounted individually or continuously with 4', 8' and 12' modular sections. Luminaires align with T-Grid and interface with all ceiling types. Iridium is suited for open offices, private offices, conference rooms, corridors, schools, libraries, labs and public spaces.

SPECIFICATION FEATURES

A ... Construction

Housing is one piece die-formed cold rolled steel, forming a 9" x 2-1/2" architectural profile. Standard 4'-0", 8'-0", and 12'-0" fixture lengths combine for continuous runs.

B ... End Caps

Standard Straight and optional Beveled end caps are precision die-cast aluminum mechanically attached without exposed fasteners.

C ... Reflectors

Reflector pan is painted with a high reflectance white powder coat finish. Optional die-formed side reflectors are highly specular anodized aluminum.

D ... Electrical

T5/T5HO fixtures are pre-wired with quick wire connectors and use UL listed Class P, T5/T5HO program rapid start universal voltage electronic ballasts, power factor of 97% with less than 10% THD. Fixtures and electrical components certified to UL and CUL standards.

E ... Finish

Fixture housings are standard white using electrostatically applied polyester powder coat paint.

Mounting

Standard aircraft cable mounts on 4'-0", 8'-0" and 12'-0" centers. Refer to installation section for various ceiling interface details and rigid pendant mounting details.

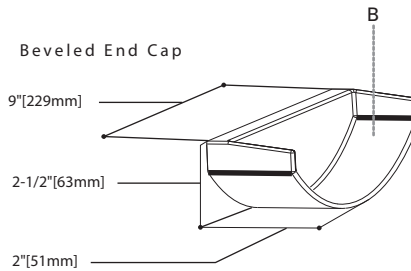
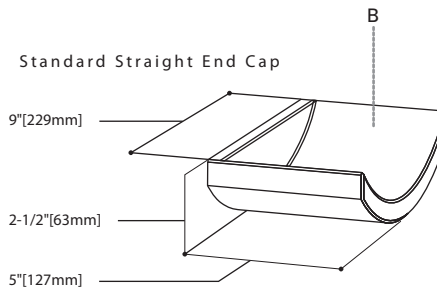
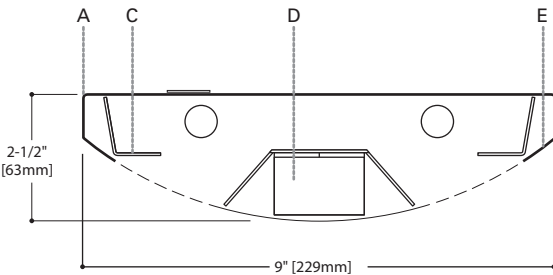

MODULES AND DIMENSIONS*

48" [1219mm]	
96" [2438mm]	
144" [3658mm]	

*Dimensions do not include end caps.

ORDERING INFORMATION

Sample Number: IP-WP-2T5-1C-UNV-AC48-T1-12-ES

Series IP: Iridium Perf Suspended	Number of Lamps 2: 2 Lamps	Wiring ¹ B: Battery Pack C: Standard Circuit D: Dimming E: Emergency T: Nightlight Y: Daylight	Voltage ¹ 120: 120V 277: 277V 347: 347V UNV: Universal (120V-277V)	Suspension A: Aircraft Cable P: Rigid Pendant	Suspension Length Fixed Cable 12", 15", 18", 21", 24", or 27" (+/- 1/2" adjustment) Adjustable Cable 48", 120", 240", 300", or 360" (infinite adjustment along entire length of cable) Rigid Pendant ² 12", 15", 18", 21", 24", or 27"	Ceiling Type T1: 1" T-Bar T9: 9/16" T-Bar TS: Slotted T-Bar ST: Structure JB: 4" Octagonal J-Box	Options ES: Straight End Cap (Standard) EB: Beveled End Cap
Optics Up S: Specular W: White	Lamp Type N5: T5 Normal Output T5: T5 High Output			Power Feed ¹ C: Straight Cord K: Curly Cord P: Rigid Pendant			
Optics Down P: Round Perf	Number of Circuits ¹ 1: 1 Circuit 2: 2 Circuits					Run Length Individually Mounted Luminaires may be 4', 8', or 12' in length Continuously Mounted Standard row configurations over 12' consist of 8' and 12' sections	

Notes: 1 Not all options available. Please consult your Cooper Lighting Representative for availability. Specifications and dimensions subject to change without notice.
 2 Consult adder section of the price guide for additional standard lengths.

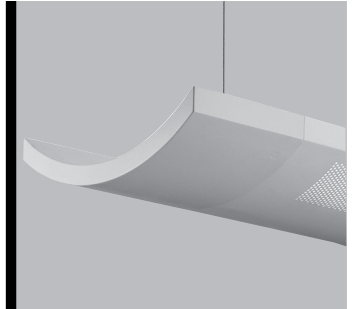

Iridium Perf

2T5
 2T5HO

Suspended
Semi-Indirect

Light Distribution
 Indirect - 92.9%
 Direct - 7.1%

PHOTOMETRICS

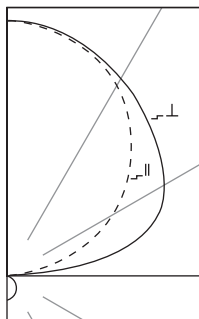

IP-WP-2T5
(2) FP54/841/HO
4500 Lumens

Efficiency 91.2%

Test Report
#LS15722

Coefficients of Utilization

rc	Effective floor cavity reflectance																		
	80%				70%				20%										
rw	70	50	30	10	70	50	30	10	50	30	10	50	30	10	50	30	10	0%	
RCR	0	88	88	88	88	77	77	77	77	54	54	54	34	34	34	15	15	15	06
	1	80	77	73	70	69	66	64	60	47	46	44	30	29	28	13	13	13	05
	2	73	67	61	57	63	58	53	50	41	38	36	26	24	23	12	11	11	04
	3	67	59	53	48	57	51	46	42	36	33	30	23	21	20	10	10	09	04
	4	61	52	45	40	52	45	39	35	32	28	26	20	18	17	09	08	08	03
	5	56	45	39	34	48	40	34	30	28	25	22	18	16	14	08	07	07	03
	6	51	41	34	29	44	35	30	26	25	22	19	16	14	12	07	06	06	02
	7	47	36	30	25	40	32	26	22	23	19	16	14	12	11	07	06	05	02
	8	43	33	26	22	37	28	23	19	20	17	14	13	11	09	06	05	04	02
	9	40	30	23	19	34	26	20	17	19	15	12	12	10	08	05	04	04	02
	10	37	27	21	17	32	23	18	15	17	13	11	11	09	07	05	04	03	01

Candela

Angle	Along	⊥	45°	Across	⊥
0	199	199	199	199	
5	200	198	198	199	
15	188	190	188	188	
25	172	176	176	176	
35	148	152	152	159	
45	114	125	136	136	
55	75	98	113	113	
65	43	75	94	94	
75	18	51	74	74	
85	1	27	49	49	
90	1	23	37	37	
95	78	394	404	404	
105	441	923	1059	1059	
115	825	1147	1440	1440	
125	1186	1377	1602	1602	
135	1502	1602	1745	1745	
145	1766	1777	1883	1883	
155	1970	1949	1976	1976	
165	2110	2087	2080	2080	
175	2182	2166	2160	2160	
180	2176	2176	2176	2176	

Zonal Lumen Summary

Zone	Lumens	%Lamp	%Fixture
0-30	152	1.69	1.85
0-40	246	2.74	3.00
0-60	429	4.77	5.23
0-90	581	6.46	7.08
40-90	335	3.72	4.08
60-90	152	1.69	1.85
90-180	7628	84.76	92.92
0-180	8209	91.22	100.00

Luminance Data

Angle in Deg	0-Deg cd/sm	45-Deg cd/sm	90-Deg cd/sm
45	1382	1517	1655
55	1117	1471	1700
65	863	1541	1833
75	599	1496	1764
85	65	1095	1486

COMMON CIRCUIT CONFIGURATIONS FOR TWO LAMP SUSPENDED FIXTURES

2C = Two circuit luminaire
 2E = Two circuit luminaire with emergency circuit
 1B = Single circuit luminaire with battery pack

/1/ = Circuit 1
 /2/ = Circuit 2
 /E/ = Emergency Circuit
 /B/ = Battery Circuit

= Power Mount

= Non-Power Mount

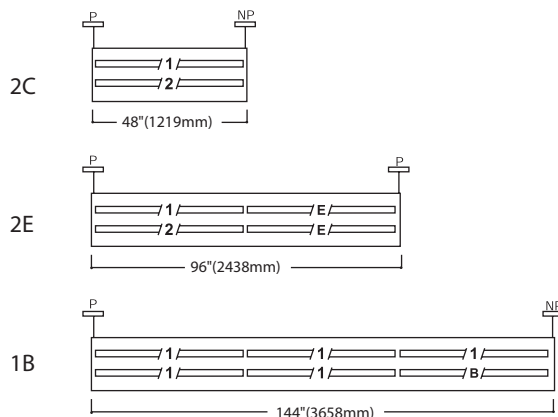

STANDARD ROW CONFIGURATIONS

FIXTURE LENGTH	4'	8'	12'	16'	20'	24'	28'	32'	36'	40'	44'	48'	52'	56'	60'	64'	68'	72'	76'	80'	84'	88'	92'	96'	100'	104'	108'	
4'	1																											
8'		1		2	1		2	1		2	1		2	1		2	1		2	1		2	1		2	1		
12'			1		1	2	1	2	3	2	3	4	3	4	5	4	5	6	5	6	7	6	7	8	7	8	9	