



Prestige™ Edge-Lit Series

Die-Cast Aluminum Edge-Lit



Standard Features

- Designed to achieve superior visual clarity and performance with a red and green LED light source.
- Virgin acrylic panel provides optimum light transmission. Illumination is 100% in both AC and the emergency mode.
- Computer engraving is used to crisply define each letter and chevron. LED sensitive inks are formulated to provide a rich color in red or green. Choice of legend background includes Clear (for single face), White or Mirror (for single or double face signs).
- Clean trim plate design eliminates visible fasteners. Choice of trim plates: Circular or Angular. Standard finish is brushed aluminum for the housing, trim-plate, trim ring and canopy.
- Self-powered models contain a sealed maintenance-free NickelCadmium battery that provides 90 minutes of emergency illumination.
- Two-wire universal 120 through 277 VAC, 50/60Hz for AC-only and self-powered models. AC-only signs consume maximum 1.4 watts. Self-powered signs use 2.3 watts max while recharging batteries. Solid state transfer automatically and instantly supplies the LED lamps from the back-up battery upon failure of AC supply. Close tolerance electronic circuit activates emergency unit when utility power dips below nominal voltage for brownout protection. Current limited and short circuit proof charger. Full battery recharge is made in compliance with UL924 specifications. Test switch incorporates a green LED AC pilot light.
- Self-test and silent diagnostic is optional on all self-powered models. It is programmed to ensure the product readiness and reliability by continuously monitoring every critical function of the unit. The unit is self-tested for one minute every 30 days, 30 minutes every 60 days and 90 minutes annually. When a fault is detected the pilot light will change color from green to red and blink following a particular code, identifying the cause: battery, charger circuitry, or LED lamps.
- Modular design allows for several mounting configurations. A trim ring and two 27-inch bar hangers are used for recessed mounting on walls or ceilings. A canopy allows for surface mounting on ceilings or walls as back- or end-mount. Face panels snap securely into trim plate on all mounting configurations.
- UL listed to UL 924 Standard.
- 5-year full warranty.

Suggested Specification

Supply and install the **EMERGI-LITE® Prestige Series™** of die-cast edge-lit exit signs. The unit shall come standard with a trim plate, trim ring, back box and canopy made of die-cast aluminum with _____ finish. The trim plate shall have a _____ profile and allow for wall- or ceiling-mount installation. The trim ring shall allow for recessed installation in walls or ceilings with cavity. The canopy shall allow for wall, end, or ceiling mount. The back box shall be provided with conduit knockouts at the top, back and end. All models shall be provided with a hardware kit including two 27-inch adjustable bar hangers for back box recessed installation. The unit shall have the trim plate snap and lock in the housing with torsion spring retainers, thereby eliminating any visible screws or hardware. The legend shall be printed on a clear acrylic panel. The panel shall have a U-shape and the legend letters shall have the contour engraved by laser. The light source shall be long-life lightemitting diodes (LED) and shall provide even illumination in normal and emergency operation. Red LED technology shall be ALINGAP. The unit shall operate with two-wire universal AC input voltage of 120 to 277Vac at less than 2.3 Watts. The edge-lit sign in a selfpowered configuration shall use a sealed Nickel-Cadmium battery and shall stay illuminated during emergency operation for at least 90 minutes upon AC failure. When specified, the self-powered unit shall include self-test and silent diagnostic functions, managed by a micro-controller: it shall execute automatic tests for one minute every 30 days, 30 minutes every 60 days and 90 minutes annually. A diagnostic circuit shall continuously monitor the performance of the battery, charger module and LED lamps. When a fault is detected the pilot light shall change color from green to red and flash with a specific code. The red light is steady-on in case of battery disconnect; it will flash with one blink for battery failure, two blinks for charger failure and four blinks for LED lamp failure. A label with the diagnostic legend shall be visible next to the pilot light. The edge-lit sign shall be tested by the Underwriting Laboratories and listed to the UL924 standard.

The unit shall be **EMERGI-LITE®** model: _____.

Electrical

Power requirements: 120 to 277VAC, 50/60Hz. AC-only signs use 1.4 watts max, Self-powered signs use 2.3 watts max while recharging batteries.

Unit Warranty*

Unit carries a 5-year full warranty. (excluding lamps and fuses)

*Subject to proper installation and maintenance.

Outline and Dimensions

Dimensions are approximate and subject to change.

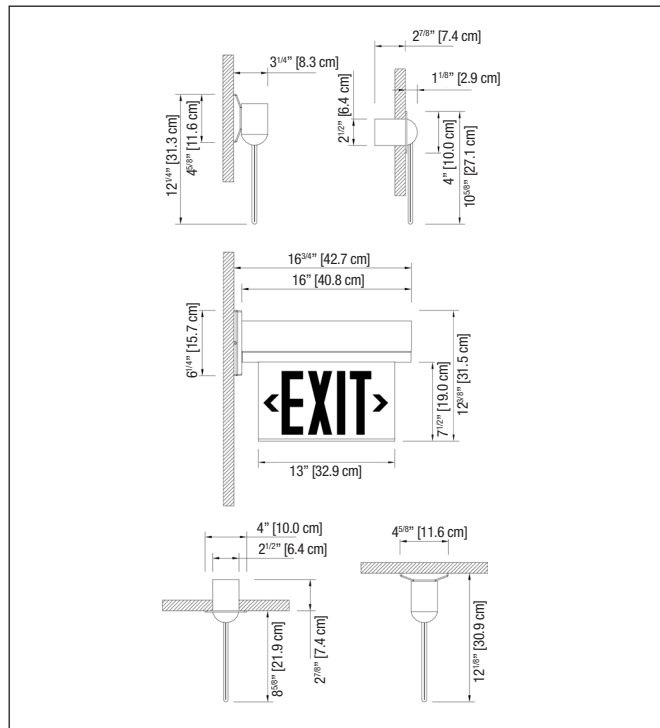

Arrow (Chevron) Designation

EXIT>	<EXIT	<EXIT>	EXIT> <EXIT
Arrow Right (R)	Arrow Left (L)	Double Arrow (D)	Arrow Right & Left (RL) Represents each side of a double face pane

*Wording and chevron's not to scale. Illustration purposes only.

Available Models

Circular trim plate models shown.

Optional Angular trim plate available

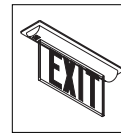

Recessed Ceiling Mount

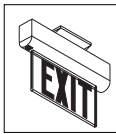

Surface Ceiling Mount

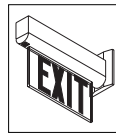

Surface End Mount

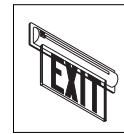

Recessed Wall Mount



Surface Wall Mount

Accessories (order as a separate item)

Description	Add Suffix
White pendant	P-WT*
Black pendant	P-BK*

*Custom pendant lengths and colors available, specify (12", 24", 36", ect)

Mounting Configurations

All mounting configurations use the same basic components. Inserting a trim ring allows for recessed mounting on walls or ceilings. Applying a canopy allows for surface mounting on ceilings or walls as back or end mount.

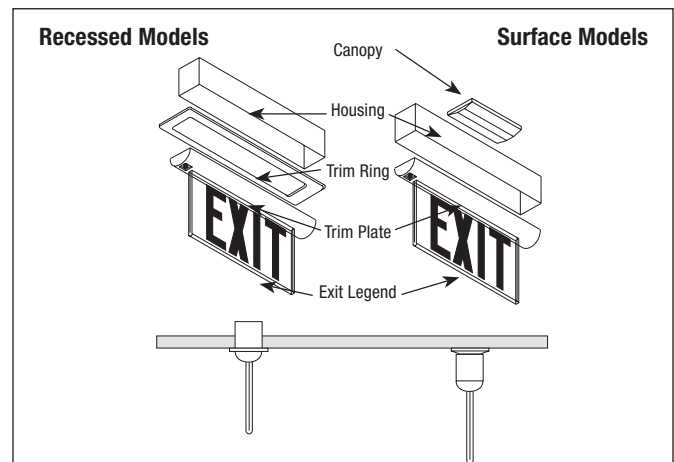
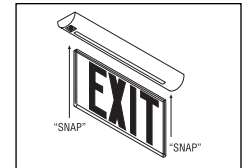

Power Consumption

Model	AC Specs		DC Specs	
AC-only	120/277 VAC	Less than 1.4W	-	-
AC/DC-remote	120/277 VAC	Less than 1.4W	6 to 24 VDC	Less than 1.4W
Self-powered	120/277 VAC	Less than 2.3W	Ni-Cd battery	Min. 90 minutes
Self-powered diagnostic	120/277 VAC	Less than 2.3W	Ni-Cd battery	Min. 90 minutes

How to Order

Housing Color	Series	Faces	Designation	Legend Color	Panel Bckgd. Color	Arrows	Trim	Mounting	Options	Legend size
Blank= Brushed aluminum W= White B= Black PB= Polished brass CH= Polished chrome BR= Bronze	LX= AC-only LXN= Self-powered	1= Single face 2= Double face	N= New design	R= Red G= Green	C= Clear (single face only) W= White M= Mirror	Blank= No arrow L= Arrow left R= Arrow right RL= Right and left (double face) D= Double arrow UA= Universal filled installed arrow	-A= Angular -C= Circular	Blank= Universal mount S= Surface mount (canopy)	Blank= No option -FA= Fire alarm -D= Self-test and diagnostic -DC=AC/DCremote 6-24 VDC -2CKT= Two circuit, AC only -FZ= Flasher & buzzer (self-powered only) -X= Back box shipped separate NEX= NEXUS® communication	Blank= 6 in EXIT legend -8= 8 in EXIT legend (red only) -LP= Panel shipped separately

EXAMPLE: WLX42NRCL-FA-8

Thomas&Betts

All information and specifications contained in this specs sheet are subject to change due to engineer design, errors and omissions. Illustrations and diagrams within this specs sheet may vary from actual products.

2013© Thomas & Betts Limited. All rights reserved. Order no. ELUSA-PRESTIGE EDGE-LIT-SPECSHEET