

Project \_\_\_\_\_

Firm Name \_\_\_\_\_

Date \_\_\_\_\_ Type \_\_\_\_\_

Series 12-ID is an indirect/direct luminaire with downlight shielding and optical choices that extends the Series 12 family to new levels of light distribution. Series 12-ID uses sophisticated designs and manufacturing techniques to produce a product that is as affordable as it is beautiful. Available in 1, 2, or 3 T8, T5 or T5HO lamps in 4' and 8' lengths. Choose from White Cross Blade perforated baffle or semi-specular Parabolic Louver, and 3 choices to control downlight distribution. Available with standard flat or optional curved die-cast endcaps. Companion wall mount also available.

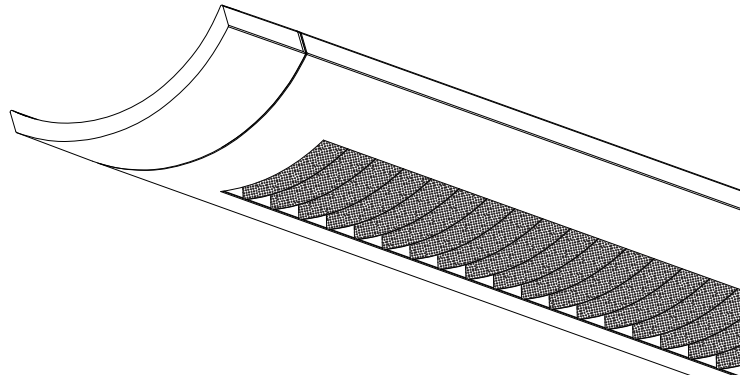

Series 12-ID with WCB white cross blade and optional die-cast curved endcap.

### FEATURES

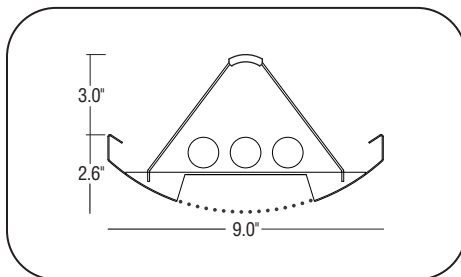

#### LAMPING

Available in 1, 2 or 3 T8, T5 or T5HO lamp cross sections.

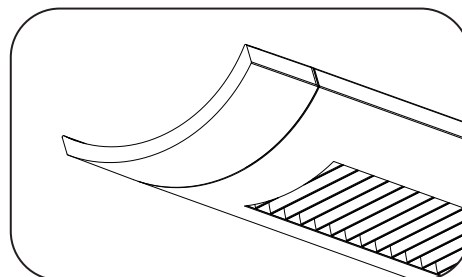

#### OPTIONAL SHIELDING

Optional semi-specular Parabolic Louver PLV shielding.

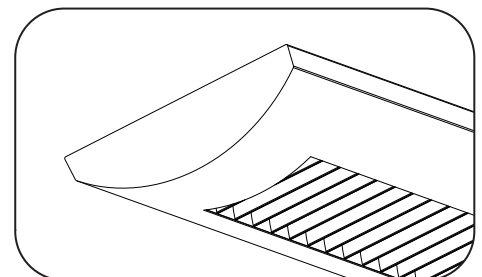

#### STANDARD ENDCAP

Standard flat endcap.

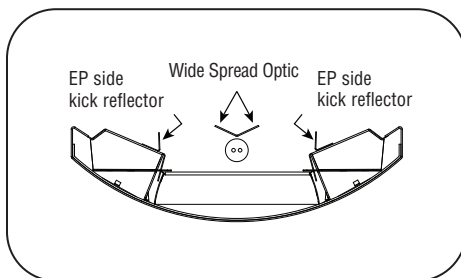

#### WSO-WIDE SPREAD OPTICS

Special wide spread reflector gives extended distribution and is especially effective in low ceiling areas.

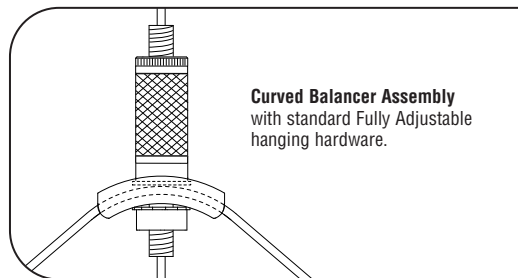

#### STANDARD FIXTURE SUPPORT

The Curved Balancer improves the strength of the hardware connection and improves installation. The balancer arrives attached to the fully adjustable hanging hardware. Simply adjust the bottom nut to the desired height, secure it to the balancer cable, adjust the side-to-side level, and secure the top nut. Install safety stop into fixture body.

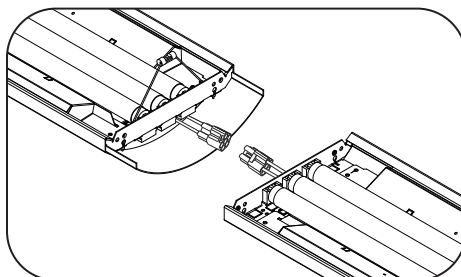
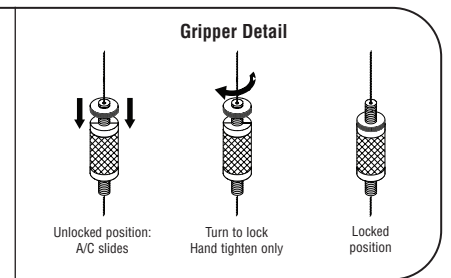

#### PLUG-TOGETHER WIRING

Standard plug-together wiring and die-formed aligner plate come factory installed for smooth joints with no light leaks.

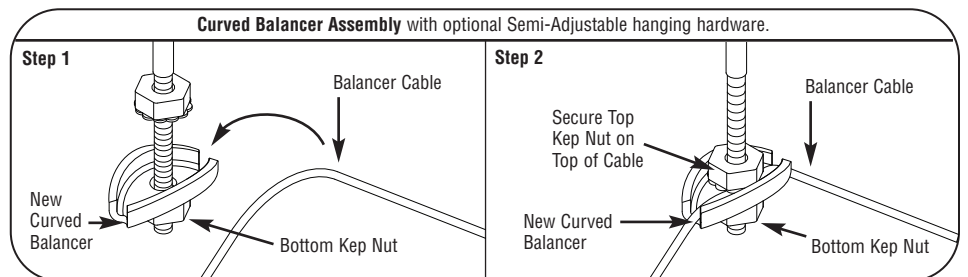

#### OPTIONAL SEMI-ADJUSTABLE CABLE SUPPORT

Optional Semi-Adjustable aircraft cable, (AC)  $\pm 0.5$ " in lengths of 12", 15", 18", 21", 24", 27", 30", 36". Aircraft cable assembly screws into the balancer. Attach Curved Balancer in the same way as Fully Adjustable assembly.

Series 12-ID is available in the lengths shown below.

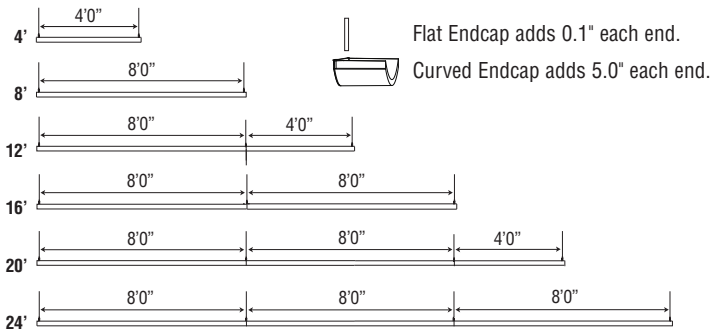

Modular section lengths offer standard 4'0" and 8'0" support spacing that aligns with grid ceiling systems.

Additional 4' or 8' segments can be added to create runs as long as required.

## CONTROLLED CENTER OPTICS

Controlled Center Optics (CCO) covers the center lamp—100% direct. Use dual switching for bi-directional control. Turn side lamps off for tightly controlled centered downlight, or turn side lamps on and center off for indirect/direct. Especially suitable for classrooms and energy conscious areas.

## SOFT TOP OPTICS

Soft Top Optics (STO) diffuses and softens the uplight with a perforated covering above the lamps. STO is helpful in applications where less light is desired on the ceiling and more direct downlight is needed.

## TOTALLY DIRECT OPTICS

With Totally Direct Optics (TDO), a covering over the lamps makes all the light reflect downward for a 100% direct fixture.

## SPECIFICATIONS

**CONSTRUCTION:** Body is 20-gauge die-formed steel with 18-gauge die-formed internal joiner system, plug-together wiring standard. All components are hard-tooled to tolerances of 0.010".

**ENDCAPS:** (FE) Flat Endcap standard, 20-gauge die-formed steel, adds 0.1" at each end.

Optional: (CE) Curved Endcap, aluminum die-cast endcap with 0.100" reveal, adds 5.0" at each end.

**REFLECTORS:** Standard (91W) 91 White: Die-formed pre-painted aluminum, 91% reflective white. Virgin acrylic-UV-stabilized lens diffuser over perforations is standard. Optional Extended Performance (EP) reflector system for T5HO. (WSO) Wide Spread Optic system for 1 T5HO.

## UPLIGHT OPTICAL OPTIONS:

- |      |   |
|------|---|
| Open | No optical control.   |
| CCO  | Controlled Center Optics, covers center lamp, 100% downlight (center only). |
| STO  | Soft Top Optic, perforations cover the surface.                             |
| TDO  | Totally Direct Optic, solid top above lamps.                                |

## DOWNLIGHT SHIELDING OPTIONS:

- |     |   |
|-----|---|
| WCB | White Cross Blade baffle, white cross blades with straight edges spaced approximately 1" apart. |
| PLV | Parabolic Louver, semi-specular louvers with straight edges, spaced approximately 1" apart.     |

**ACCESSORY:** Optional Dust Cover, clear acrylic, T8 lamps only. NOTE: Will significantly impact light level performance. Contact Factory.

**ELECTRICAL:** 120 or 277V prewired. Fixture and electrical components are UL/C-UL listed and fixture will bear UL/C-UL labels. Optional Adders: Low profile 347V ballast, prewired dual circuit, emergency circuits, low profile emergency battery packs. Contact factory.

**LAMPING:** Available in 1, 2 or 3 T8, T5 or T5HO lamp cross sections.

**BALLAST:** Electronic instant-start ballast <10% THD, .88 BF standard for T8 lamps. Electronic rapid-start ballasts <10% THD, 1.0 BF standard for T5/T5HO lamps. Optional adders: rapid-start ballasts (standard for T5/T5HO), 347V, emergency battery packs, dimming ballasts (controls by others). Requires low-profile ballasts and battery packs. Contact factory for multiple ballast factors in one luminaire.

**MOUNTING OPTIONS:** Standard (FA) fully adjustable aircraft cable with safety stop in lengths up to 150". Mounting connects to fixture with factory-installed Level and Lock Assembly™, which allows side-to-side fixture leveling and locks into place. NOTE: Curved balancer assembly is 3" above top of fixture. Optional (AC) semi-adjustable aircraft cable ( $\pm 0.5$ ") in lengths of 12", 15", 18", 21", 24", 27", 30", and 36".

Optional: (AC) Semi-adjustable aircraft cable ( $\pm 0.5$ ) in lengths of 12, 15, 18, 21, 24, 27, 30, 36.

**SUPPORT CABLES:** Plated steel cable and hardware.

**FEED:** 18 gauge straight cord. 14 gauge feed cord used when fixture current exceeds 6 amps. Optional Adders: Coil Cord Feed.

**FINISHES:** Finelite Signal White standard. Optional Adders: 185 colors available from Tiger Drylac's RAL color chart.

**LENGTHS:** 4' and 8' section lengths can be combined to make longer runs. Contact factory for additional lengths.

**WEIGHT:** Fixture weight = 2.6 to 3.6 lb/ft. with curved endcaps. Fixture weight 2.0 lb/ft. with flat endcaps.

**WALL MOUNT:** Complementary wall mount available.

## ORDERING GUIDE

S12-ID - WCB - 32' - 2T8 - SC - 91W - OPEN - 277 - FA - FE - C1 - .88

Finelite Series 12-ID (Indirect/Direct)	_____
Shielding (WCB, PLV)	_____
Run length (4', 8' multiples standard)	_____
Number of lamps in cross section (1, 2, 3, T8, T5 or T5HO)	_____
Circuiting (SC-single circuit, DC-dual circuit, CRD-center row dimming)	_____
Reflector system (91W, EP, WSO)	_____
Uplight optical options (Open, CCO, STO, TDO)	_____
Voltage (120, 277, 347V)	_____
Mounting (AC/FA)	_____
Endcap FE (flat), CE (curved)	_____
Ceiling type (C1-1" T-bar, C2-9/16" T-bar, C3-Slot Grid, C4-Hard Ceiling)	_____
Ballast factor (Standard .88 for T8 lamps, 1.0 for T5 or T5HO)	_____