

Specification Sheet : H7-UNV-150HSC

150W MH M102, M142, M81, C142, M107
120-277V 50/60 Hz SIDE LEADS

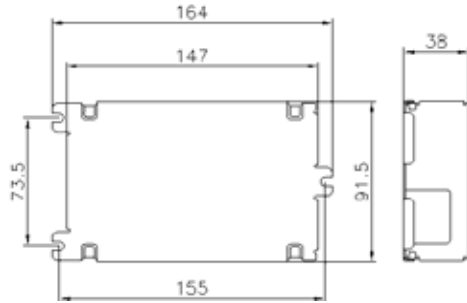

Mechanical Data:



CASE MATERIAL
CASE LENGTH
CASE WIDTH
HEIGHT
OVERALL LENGTH
MOUNTING LENGTH
WEIGHT

ALUMINUM
147mm, 5.79"
91.5mm, 3.60"
38mm, 1.50"
164mm, 6.46"
155mm, 6.10"
1.76 lbs

Hot Spot:

Tcase max: 85°C



Electrical Data:

LAMP
INPUT VOLTS
LINE CURRENT (AMPS)
INPUT POWER (WATTS)
MIN POWER FACTOR
MIN STARTING TEMPERATURE
THD
ANSI CODE
CCF
EMI/RFI
FREQUENCY

1 LAMP, 150W MH	
120	277
1.54	0.61
164W	
>0.95	
-30°C/-20°F	
<15%	
M102, M142, M81, C142, M107	
<1.5	
FCC PART18 CLASS A, NON-CONSUMER	
140-220 Hz	

Wiring Diagram:

WIRE	BLACK	WHITE	RED	BLUE	GREEN
LENGTH	12"	12"	12"	12"	12"

Bottom View, Side Leads

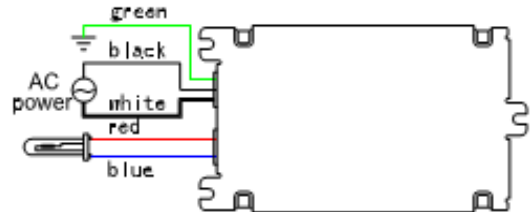

Ballast Case Must Be Grounded.

Installation & Application:

- Maximum allowable case temperature is 85°C. See Hot Spot section for measurement location.
- Ignition pulse is 4kV max.
- Ballast output will shutdown after 25 minutes if lamp fails to ignite.
- Power must be cycled off then on, after replacing lamp.
- Do not install insulation above or within 3 inches of ballast sides
- Can be remotely installed up to 12 feet from lamp.

Performance:

- Short Circuit Operation Protection
- Open Circuit Operation Protection
- Ignitor Failure Protection
- Thermal Protection
- End of Lamp Life Protection