

ANNOUNCING OUR NEW! 100-240VAC 2W LED ROUND, RECTANGULAR AND SCOOP STEP AND PATHWAY LIGHT! YOUR SAMPLES ARE ENCLOSED!

Step and pathway lighting has become a bit brighter with the introduction of GM Lighting's NEW 100-240VAC 2W LED Scoop Step and Pathway Light. The Scoops's warm white LED glow will punctuate the darkness and add a stylish focal point where pedestrian visibility is key.

- 2W LED lamping
- Brushed Nickel, Black or White finishes
- Solid die-cast face plates
- Indoor / Outdoor Applications
- 50,000 hr. life
- Easy to mount • Low maintenance



STLS-LT-B



STLS-ST-BNK



STLR-LT-BZ

| Catalog No. | Description | Wattage | Dimensions | Finish | LED Life |
|-------------|-----------------------------|---------|-----------------------------|----------------|-------------|
| STLR-FT-W | Round Shield | 2W | 4-3/4"R x 5/16"D | White | 50,000 hrs. |
| STLR-FT-B | Round Shield | 2W | 4-3/4"R x 5/16"D | Black | 50,000 hrs. |
| STLR-FT-BNK | Round Shield | 2W | 4-3/4"R x 5/16"D | Brushed Nickel | 50,000 hrs. |
| STLR-FT-BZ | Round Shield | 2W | 4-3/4"R x 5/16"D | Bronze | 50,000 hrs. |
| STLR-LT-W | Round Louvered Shield | 2W | 4-3/4"R x 5/16"D | White | 50,000 hrs. |
| STLR-LT-B | Round Louvered Shield | 2W | 4-3/4"R x 5/16"D | Black | 50,000 hrs. |
| STLR-LT-BNK | Round Louvered Shield | 2W | 4-3/4"R x 5/16"D | Brushed Nickel | 50,000 hrs. |
| STLR-LT-BZ | Round Louvered Shield | 2W | 4-3/4"R x 5/16"D | Bronze | 50,000 hrs. |
| STLS-FT-W | Rectangular Shield | 2W | 5-1/4"W x 3-1/4"H x 3/8"D | White | 50,000 hrs. |
| STLS-FT-B | Rectangular Shield | 2W | 5-1/4"W x 3-1/4"H x 3/8"D | Black | 50,000 hrs. |
| STLS-FT-BNK | Rectangular Shield | 2W | 5-1/4"W x 3-1/4"H x 3/8"D | Brushed Nickel | 50,000 hrs. |
| STLS-FT-BZ | Rectangular Shield | 2W | 5-1/4"W x 3-1/4"H x 3/8"D | Bronze | 50,000 hrs. |
| STLS-LT-W | Rectangular Louvered Shield | 2W | 5-1/4"W x 3-1/4"H x 3/8"D | White | 50,000 hrs. |
| STLS-LT-B | Rectangular Louvered Shield | 2W | 5-1/4"W x 3-1/4"H x 3/8"D | Black | 50,000 hrs. |
| STLS-LT-BNK | Rectangular Louvered Shield | 2W | 5-1/4"W x 3-1/4"H x 3/8"D | Brushed Nickel | 50,000 hrs. |
| STLS-LT-BZ | Rectangular Louvered Shield | 2W | 5-1/4"W x 3-1/4"H x 3/8"D | Bronze | 50,000 hrs. |
| STLS-ST-W | Scoop Shield | 2W | 5-1/8"H x 3-1/8"W x 1-1/8"D | White | 50,000 hrs. |
| STLS-ST-B | Scoop Shield | 2W | 5-1/8"H x 3-1/8"W x 1-1/8"D | Black | 50,000 hrs. |
| STLS-ST-BNK | Scoop Shield | 2W | 5-1/8"H x 3-1/8"W x 1-1/8"D | Brushed Nickel | 50,000 hrs. |
| STLS-ST-BZ | Scoop Shield | 2W | 5-1/8"H x 3-1/8"W x 1-1/8"D | Bronze | 50,000 hrs. |

For a full line of spec sheets and mounting instructions, please see our website at www.gmlighting.net

100-240VAC LED RECTANGULAR AND ROUND PATHWAY LIGHT DIAGRAM

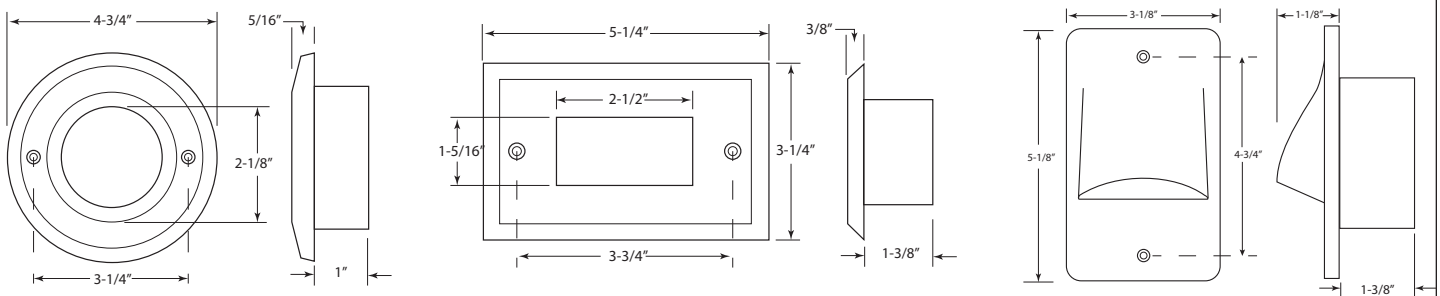

9830 W. 190th Street • Unit F • Mokena, IL 60448 • Toll-Free (866) 671-0811 • FAX: (708) 478-2640
www.gmlighting.net