

66F-G

SERIES PREMIUM RECESSED LUMINAIRE FLANGED OR GRID TYPE

Job Name

Catalog Number

Notes

Type

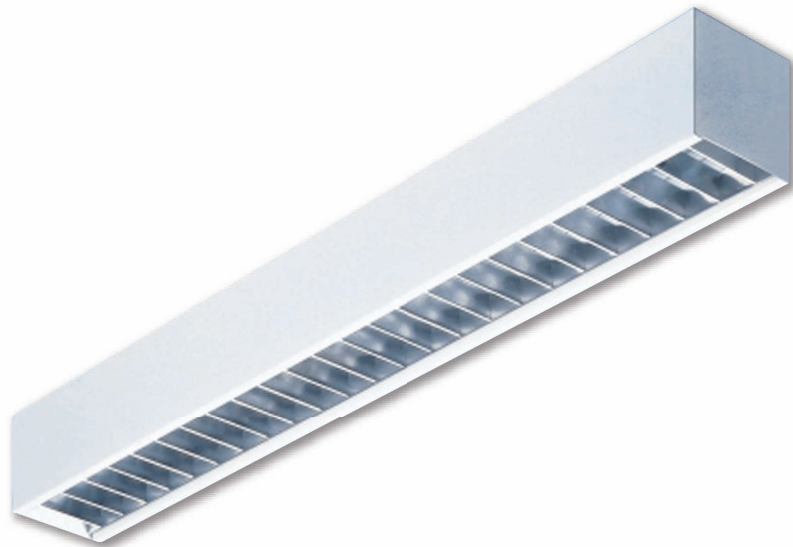

application

- A narrow 6 in. by 6 in. recessed luminaire designed for distinctive architectural interiors
- Ideal for perimeters, soffits, coves or other commercial applications where modern lighting may be utilized in grid, sheet-rock or concealed-z ceilings
- Able to be mounted individually or in continuous rows
- Available with various louver options and numerous ballast/lamp combinations

finish

- Prior to painting, all metal parts are treated with a multi-stage phosphate bonding process to ensure adhesion and inhibit rusting
- Painted with a lighting grade baked white enamel, having a reflectance factor exceeding 87% for premium quality and durability

construction

- The 66F and G series are premium fluorescent luminaires designed for long term installations
- Features durable steel bodies, quality paint finishes and superior electrical components
- Bodies are die formed from 20 gauge New York City code cold rolled steel
- Ample knockouts are provided on side and ends for convenient installation and continuous through wiring
- The 66F comes with lugs and adjustable end flange trims

electrical

- All fixtures are U.L. listed and IBEW union made
- All electrical components are U.L. listed
- Electronic Class P, thermally protected ballasts standard
- Numerous options are available: see ordering information on back

diffuser

- Standard prismatic lens provides high efficiency with maximum visual comfort and uniform light diffusion
- Low brightness, 100% virgin acrylic clear prismatic lens is standard, consult ordering guide for optional diffusers and louvers
- Optional white acrylic overlay for use with louvers available - see ordering guide

LaMar
Lighting
Company, Inc.

66F-G SERIES

PREMIUM ARCHITECTURAL
LUMINAIRE
FLANGED OR GRID TYPE

ordering guide

NOTE: SOME ORDERING OPTIONS APPEAR ON PRODUCT LINE.
FOR OTHER OPTIONS, SEE LIST AT RIGHT.

SAMPLE ORDER NUMBER



SERIES NO. WATTAGE TANDEM MOUNT OPTIONS BALLAST TYPE VOLTAGE LENS OPTIONS 1 2 DIMENSIONS LAMP TYPE

T-12 ORDERING GUIDE											
66	1, 2	20		G, F	M2, MP	1, 7, U	PA			6" x 24"	F20T12
66	1, 2	30		G, F	M2	1, 7, U	PA			6" x 36"	F30T12
66	1, 2	40		G, F	M2	1, 7	PA			6" x 48"	F40T12
66	1, 2	30	T	G, F	M2	1, 7	PA			6" x 72"	F30T12
66	1, 2	40	T	G, F	M2	1, 7	PA			6" x 96"	F40T12
66	1, 2	72		G, F	M2	1, 7	PA			6" x 72"	F72T12
66	1, 2	96		G, F	M2	1, 7	PA			6" x 96"	F96T12

T-8 ORDERING GUIDE											
66	1, 2	17		G, F	E8	1, 7, U	PA			6" x 24"	F17T8
66	1, 2	25		G, F	E8	1, 7, U	PA			6" x 36"	F25T8
66	1, 2	32		G, F	E8	1, 7, U	PA			6" x 48"	F32T8
66	1, 2	25	T	G, F	E8	1, 7, U	PA			6" x 72"	F25T8
66	1, 2	32	T	G, F	E8	1, 7, U	PA			6" x 96"	F32T8
66	1, 2	96		G, F	E8, H8	1, 7, U	PA			6" x 96"	F96T8/F96T8HO

Note: Tandem units contain double the amount of lamps shown

dimensional data

NOTE: SPECIFICATIONS AND DIMENSIONAL DATA ARE SUBJECT
TO CHANGE WITHOUT NOTICE.

cross sections

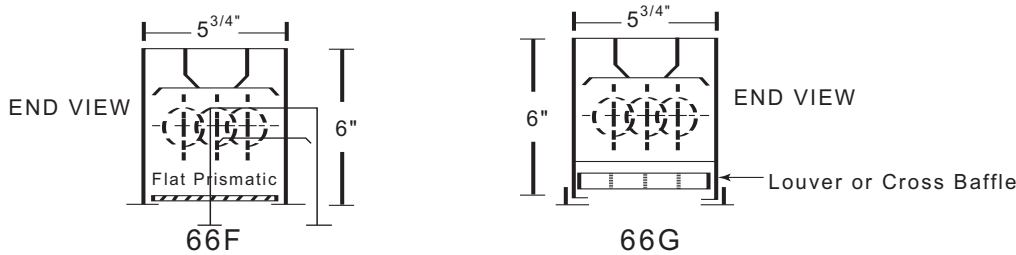

back knockout plans lengths

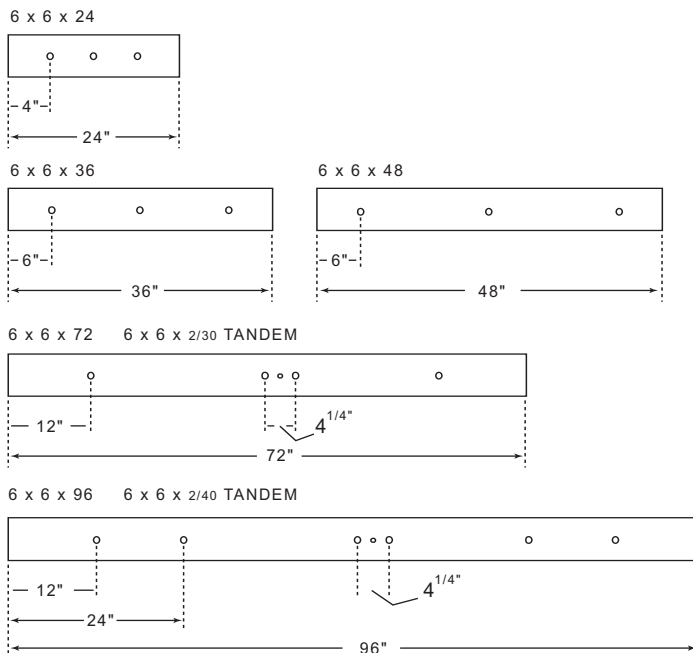

Revised
10/08

options

OPTIONS: INSERT APPROPRIATE CODE FOR
CUSTOMIZED ORDERING

BALLAST

E5 Electronic T5
H5 Electronic T5 HO
E8 Electronic T8
ED Electronic Dimming
(Consult Factory)

NOTE: In order to achieve rated lamp life,
fixtures controlled by motion sensors should
be ordered with programmed start ballasts
when available and minimum time delay
should be set to 15 minutes - Consult Factory

VOLTAGE

1 120V
7 277V
U Universal 120 - 277V

GENERAL OPTIONS

EM Emergency pack, 1 lamp
90 min. up to 500 lu.
2C 2 Circuit
OVL White Acrylic Overlay

MOUNTING OPTIONS

G T-bar or grid ceiling
F Flanged for finished ceiling,
sheetrock, plaster, concealed "Z"

LENS & LOUVER OPTIONS

PA Prismatic acrylic
CW White cross baffle
PS Parabolic silver baffle
S1 Nominal .75 X .75 silver louver
S2 Nominal 1.5 X 1.5 silver louver

accessories

LAMP OPTIONS

12 T8 741K
15 T8 735K
10 T8 730K
13 T8 841K
16 T8 835K
11 T8 830K

LAMAR LIGHTING 485 Smith Street, Farmingdale, NY 11735 • Tel (631) 777-7700
Fax (631) 777-7705 • Outside NY (800) 724-7743 • www.lamarlighting.com

Lamar
Lighting
Company, Inc.