

C 2 SERIES CORDELIA

Job Name	
Catalog Number	
Notes	Type

Scan QR code to be directed to this product on the web!



features

- A unique bi-level luminaire controlled by an integral ultra-sonic motion sensor, designed to provide safe, dependable illumination while conserving energy. Suitable for ceiling or wall mounting
- Bi-level fixtures operate at a low standby light level, offering energy savings, safety and security with full light output instantly upon occupancy with areas fully lit only as needed
- Ideal for stairwells, restrooms, laundry rooms and other areas where maximum light levels are not required on a constant basis
- The ultra-sonic sensor features enhanced sensitivity and a lamp conditioning circuit (patented) that keeps new lamps on for 100 hours to assure long lamp life and proper operation
- For safety and compliance purposes in areas designated as emergency egress, we recommend choosing a standby light level that will provide minimum code compliant light levels while in the standby mode. In most municipalities, this is 1 FC average. See back for options

construction

- Housings are die-formed of code gauge steel, with riveted end plates and socket supports
- Quality construction throughout for long-term dependable service
- Vandal resistant options including heavy gauge end plates, tamper-proof screws and hi-impact diffusers
- Ample knockouts are provided for convenient mounting with recessed or surface power feeds
- New York City Department of Buildings calendar #4525
- All fixtures are U.L. listed and IBEW union made
- Premium lamp holders with rotary lock standard

diffuser

- One-piece extruded clear, light stabilized acrylic is standard
- Features a linear refractive pattern for even illumination
- Grooved formation on the edges allow for a tight, no light leak attachment to the body
- Optional polycarbonate lens

All units are U.L. listed as emergency power and lighting equipment (U.L.-924) when equipped with optional battery back-up and meet requirements of the life safety code/NFPA101, NEC/OSHA and most state and local codes.

electrical

- All electrical components are U.L. listed
- Electronic Class P ballasts standard, CEE approved
- Optional battery backup available for one or two light emergency operation at various output levels. Please consult factory for your specific emergency pack requirements

finish

- Painted with a lighting grade baked white enamel, having a reflectance factor exceeding 87% for premium quality and durability
- Prior to painting, all metal parts are treated with a multi-stage phosphate bonding process to ensure adhesion and inhibit rusting

sensor

- High frequency, extremely sensitive ultra-sonic, internally mounted
- LED status indicator light
- Exclusive lamp conditioning circuit (patented)
- Fail-safe feature switches light level to high (100%) if sensor is physically damaged
- 5 minute walk-test feature, easy-set time and sensitivity controls, compact design

**LaMar
Lighting**
Company, Inc.

occu-smart[®]
technology

Occu-smart is a registered trademark of LaMar Lighting Co., Inc.

Protected by one or more US Patents
Nos. 7,271,543 & 7,081,715

C 2 SERIES

CORDELIA

ordering guide

NOTE: SOME ORDERING OPTIONS APPEAR ON PRODUCT LINE FOR OTHER OPTIONS, SEE LIST AT RIGHT

SAMPLE ORDER NUMBER



SERIES NO. WATTAGE TANDEM BALLAST VOLTAGE LENS LIGHTING OPTION DIMENSIONS LAMP TYPE
LAMPS LAMPS TYPE TYPE OPTION OPTION TYPE

T-8 ORDERING GUIDE

C2	1	17		C8	U	PA, PF, PC	FO, AS			6" x 24"	F17T8
C2	1	25		C8	U	PA, PF, PC	FO, AS			6" x 36"	F25T8
C2	1	25	T	C8	U	PA, PF, PC	2C, FO, AS			6" x 72"	F25T8
C2	1	32		C8	U	PA, PF, PC	FO, AS			6" x 48"	F32T8
C2	1	32	T	C8	U	PA, PF, PC	2C, FO, AS			6" x 96"	F32T8
C2	2	17		C8	U	PA, PF, PC	2C, FO, AS			6" x 24"	F17T8
C2	2	25		C8	U	PA, PF, PC	2C, FO, AS			6" x 36"	F25T8
C2	2	25	T	C8	U	PA, PF, PC	2C, FO, AS			6" x 36"	F25T8
C2	2	32		C8	U	PA, PF, PC	2C, FO, AS			6" x 48"	F32T8
C2	2	32	T	C8	U	PA, PF, PC	2C, FO, AS			6" x 96"	F32T8

NOTE: TANDEM UNITS CONTAIN DOUBLE THE AMOUNT OF LAMPS SHOWN

dimensional data

NOTE: SPECIFICATIONS AND DIMENSIONAL DATA ARE SUBJECT TO CHANGE WITHOUT NOTICE

cross sections

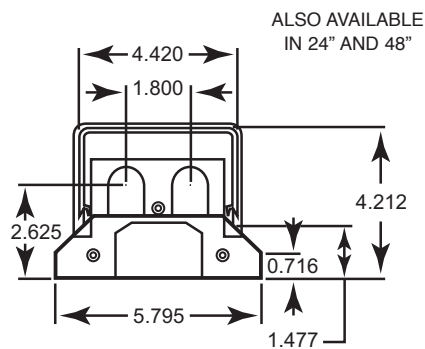
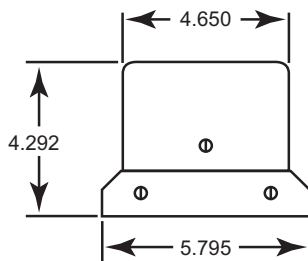
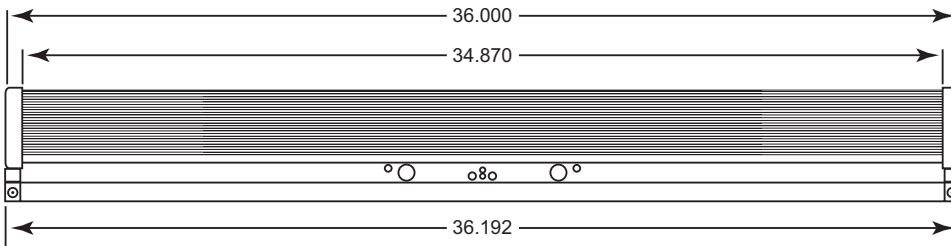

ALSO AVAILABLE IN 24" AND 48"

(2) F32T8@10%=14W	(1) F32T8@10%=8W
(2) F32T8@100%=68W	(1) F32T8@100%=35W
(2) F17T8@10%=11W	(1) F17T8@10%=7W
(2) F17T8@100%=36W	(1) F17T8@100%=20W

options

OPTIONS: INSERT APPROPRIATE CODE FOR CUSTOMIZED ORDERING

BALLAST

C8 CEE listed high performance T8 Program rapid start ballasts are used for lamps that are cycled on/off or dimmed Instant start ballasts are used for lamps that are not cycled or dimmed

Most non-dimming models may be used to operate reduced wattage 4' T8 lamps (25/28W) limited to operation above 60°F ambient temperature - Consult factory or specific ballast manufacturer

VOLTAGE

U Universal 120-277V

DIFFUSER OPTIONS

PA Prismatic acrylic
PC Polycarbonate
PF Perforated metal

LIGHTING OPTIONS

2C 1 lamp on constantly/1 lamp sensed
FO All lamps on/off, All lamps sensed on
AS User selectable standby options 5, 10, 20 & 40% Nominal Light Output

GENERAL OPTIONS

LW Low watt ballast
EM Emergency pack, 1 lamp 90 min. up to 500 lu.
TP Heavy gauge ends, tamper-proof screws

Consult Factory for higher lumen battery pack availability and additional options not shown or listed

accessories

LAMP OPTIONS

12 T8 741K
15 T8 735K
10 T8 730K
13 T8 841K
16 T8 835K
11 T8 830K

BEFORE INSTALLATION, PLEASE CONSULT YOUR LOCAL ORDINANCES AND BUILDING CODES FOR COMPLIANCE

occu-smart[®]
technology

Protected by one or more US Patents
Nos. 7,271,543 & 7,081,715

Revised
7/12

LAMAR LIGHTING 485 Smith Street, Farmingdale, NY 11735 • Tel (631) 777-7700
Fax (631) 777-7705 • Outside NY (800) 724-7743 • www.lamarlighting.com

Scan QR code to be directed to our home page!



Lamar
Lighting
Company, Inc.