

CA

Intended Use

For surface ceiling-mount applications where a narrow-profile architectural appearance is desired. Ideal for areas such as corridors or stairwells where narrow width is important.

Construction

Companion to AW Series, only 5-1/4" wide.

Choice of flat-bottom diffusers – prismatic acrylic or matte

white opal acrylic. Both available in high-impact versions.

Diffuser held by four torsion springs. Hinges open from either side for easy cleaning and service.

Slim, low-profile housing for ceiling or wall mounting.

White housing standard. Matte black optional.

For surface or stem mounting, unit or row installation. For stem mounting on two-

lamp and four-lamp, order two stem accessories.

Electrical

Ballast disconnect provided standard where required to comply with U.S. and Canadian electrical codes.

Listings

UL Listed. CUL Listed or CSA Certified to Canadian standards—optional. NOM Certified—optional.

**ORDERING INFORMATION**

For shortest lead times, configure products using **bolded options**.

Example: CA 2 32 MVOLT GEB10IS

Series ¹	Number of lamps	Lamp type	Diffuser	Voltage	Ballast configuration
CA	1	14T5 14W T5 (22")	(blank) Prismatic	MVOLT 347 ²	(blank) 1- and/or 2-lamp ballasts per Lithonia Lighting standards
	2	17 17W T8 (24")	AR High-impact prismatic		1/4 One 4-lamp ballast
	Not included.	21T5 21W T5 (34") ⁵	ACW Matte white		
		25 25W T8 (36")	AWR High-impact matte white		
		28T5 28W T5 (46") ⁵			
		32 32W T8 (48")			

Ballast

GEB10IS T8 electronic ballast, ≤10% THD, instant start
GEB10RS T8 electronic ballast, ≤10% THD, programmed rapid start
GEB10PS T5 electronic ballast, ≤ 10% THD, programmed rapid start
BINP T8 high-performance ballast, normal ballast factor (.88), instant start³

Options

EL Emergency battery pack⁴
MB Matte black
CSA Meets Canadian standards
NOM Meets Mexican standards

ADDITIONAL INFORMATION

For additional product information, visit www.lithonia.com.

SERIES	LAMPS PER CROSS SECTION	LAMPS PER FIXTURE	CONFIGURATIONS			
			LAMP TYPE	LENGTH IN. (CM)	WIDTH IN. (CM)	HEIGHT IN. (CM)
CA	1	1	17, 14T5	24-1/2 (62.2)	5-1/4 (13.3)	4-5/8 (11.7)
CA	2	2	17, 14T5	24-1/2 (62.2)	5-1/4 (13.3)	4-5/8 (11.7)
CA	1	1	25, 21T5	36-1/2 (92.7)	5-1/4 (13.3)	4-5/8 (11.7)
CA	2	2	25, 21T5	36-1/2 (92.7)	5-1/4 (13.3)	4-5/8 (11.7)
CA	1	1	32, 28T5	48-1/2 (123.2)	5-1/4 (13.3)	4-5/8 (11.7)
CA	2	2	32, 28T5	48-1/2 (123.2)	5-1/4 (13.3)	4-5/8 (11.7)
TCA	1	2	32	97 (246.4)	5-1/4 (13.3)	4-5/8 (11.7)
TCA	2	4	32	97 (246.4)	5-1/4 (13.3)	4-5/8 (11.7)

Drawings are for dimensional detail only and may not represent actual mechanical configuration. Dimensions are shown in inches (centimeters) unless otherwise noted.

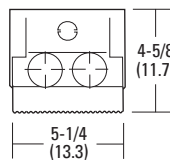
**Notes**

- For tandem double-length unit, add prefix T. Example: TCA.
- Available only with CSA option.
- Consult www.lithonia.com for additional high-performance ballast options.
- Consult www.lithonia.com for available options.
- T5 configurations not available in tandem lengths.