

# MARK<sup>®</sup> ARCHITECTURAL LIGHTING



## The MP Series

MP offers virtually shadowless perimeter lighting. Staggered lamps and telescopic strips ensure even illumination from wall to wall. The staggered and telescoping strips snap into clevises within the outer housing to facilitate quick and easy installation.

MP features uninterrupted shielding throughout each fixture run, including corners. Shielding choices include extruded aluminum baffle, parabolic baffle, clear prismatic lens and soft white acrylic.

Type:

Project:

Catalog Number:

DO NOT TYPE HERE. Autopopulated field.

## Specification Features

### Housing

Die-formed, 20-gauge, cold-rolled steel.

### Trim

Precision-extruded aluminum.

### Trimable Housing

Die-formed aluminum.

### Finish

Matte white.

### Reflector

Diffuse aluminum.

### Shielding

Extruded aluminum bold baffle, parabolic baffle, clear prismatic lens or soft-white acrylic.

### Lamps

(1) or (2) T8, T5 or T5HO with 3" stag-

ger. Strips snap into clevises within outer housings. Last strip is telescopic. Lamps provided by others.

### Ballast

Thermally protected Class P energy-saving electronic ballast.

### Mounting

Recessed perimeter wall wash in 8', 6', 4', 3' and 2' sections.

### Corners

90- and 135-degree inside or outside, available as standard units.

### Certification

cULus Listed, IBEW (Local 3) Union-made in the USA.

## Technical Drawings

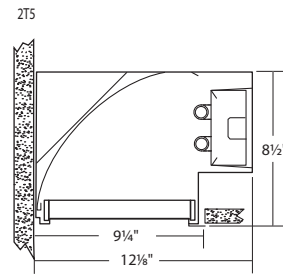

## Ordering

Example: MP 16FT 2T5S EBPR 120 PB2

| Series | Length <sup>1</sup>                  | No. of lamps/Lamp type <sup>2</sup> | Ballast   | Voltage   | Shielding  | Options  |  |
|--------|--------------------------------------|-------------------------------------|---|---|--|--|--|
| MP     | _ft. Provide wall-to-wall dimensions | Number of lamps<br><b>1</b><br>2    | Lamp type <sup>2</sup><br><b>T5S</b><br>T5HO<br>T8S | <b>EBPR</b> Program rapid start (standard)<br><b>EBIS</b> Instant start<br><b>EDB</b> Dimming (specify)<br><b>EDHL</b> Lutron Hi-Lume® dimming<br><b>EDE10</b> Lutron Eco-10® dimming<br><b>EDES</b> Lutron Eco System® | <b>120</b><br><b>277</b><br><b>347<sup>3</sup></b> | <b>EBB</b> Extruded aluminum bold baffle, 3/16" blades 1" h. x 1.2" o.c.<br><b>PB2</b> Parabolic louver, blades 2" h. X 4" o.c. diffuse aluminum<br><b>PA</b> Clear prismatic acrylic, K12 pattern<br><b>SW</b> Soft-white acrylic | <b>EMPK</b> Emergency battery pack<br><b>CP</b> Chicago plenum |

### Notes

- 1 Provide field dimensions when placing order. For patterns, clearly indicate inside or outside corners. Upon request, factory will prepare installation drawings for approval.
- 2 Consult factory for other lamps.
- 3 Consult factory for lamp and ballast compatibility.