

MARK®
ARCHITECTURAL
LIGHTING



The MP Series

MP offers virtually shadowless perimeter lighting. Staggered lamps and telescopic strips ensure even illumination from wall to wall. The staggered and telescoping strips snap into clevises within the outer housing to facilitate quick and easy installation.

MP features uninterrupted shielding throughout each fixture run, including corners. Shielding choices include extruded aluminum baffle, parabolic baffle, clear prismatic lens and soft white acrylic.

Type:

Project:

Catalog Number:

DO NOT TYPE HERE. Autopopulated field.

Specification Features

Housing

Die-formed, 20-gauge, cold-rolled steel.

Trim

Precision-extruded aluminum.

Trimable Housing

Die-formed aluminum.

Finish

Matte white.

Reflector

Diffuse aluminum.

Shielding

Extruded aluminum bold baffle, parabolic baffle, clear prismatic lens or soft-white acrylic.

Lamps

(1) or (2) T8, T5 or T5HO with 3" stag-

ger. Strips snap into clevises within outer housings. Last strip is telescopic. Lamps provided by others.

Ballast

Thermally protected Class P energy-saving electronic ballast.

Mounting

Recessed perimeter wall wash in 8', 6', 4', 3' and 2' sections.

Corners

90- and 135-degree inside or outside, available as standard units.

Certification

cULus Listed, IBEW (Local 3) Union-made in the USA.

Technical Drawings

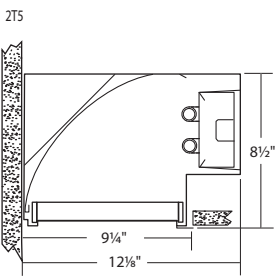

Ordering

Example: MP 16FT 2T5S EBPR 120 PB2

Series	Length ¹	No. of lamps/Lamp type ²		Ballast	Voltage	Shielding	Options
MP	ft. Provide wall-to-wall dimensions	Number of lamps	Lamp type ²	EBPR Program rapid start (standard)	120	EBB Extruded aluminum bold baffle, 3/16" blades 1" h. x 1.2" o.c.	EMPK Emergency battery pack
		1	T5S	EBIS Instant start	277	PB2 Parabolic louver, blades 2" h. X 4" o.c. diffuse aluminum	CP Chicago plenum
		2	T5HOS	EDB Dimming (specify)	347 ³	PA Clear prismatic acrylic, K12 pattern	
			T8S	EDHL Lutron Hi-Lume® dimming		SW Soft-white acrylic	
				EDE10 Lutron Eco-10® dimming			
				EDES Lutron Eco System®			

Notes

- 1 Provide field dimensions when placing order. For patterns, clearly indicate inside or outside corners. Upon request, factory will prepare installation drawings for approval.
- 2 Consult factory for other lamps.
- 3 Consult factory for lamp and ballast compatibility.