

## DESCRIPTION

The IA Series is an energy efficient family of light duty industrial fixtures that feature premium performance and durability. The series incorporates sturdy embossed reflectors that precisely direct and effectively control light. The IA Series can be installed using various mounting methods and numerous options and accessories are available. The series is available with both Apertured (IA) and Closed Top (IC) reflector combinations.

## APPLICATION

The IA Series can be utilized in simple task and area lighting and industrial applications.

## SPECIFICATION FEATURES

### A...Construction

Nominal Channel is code gauge prime cold rolled steel. Numerous KOs for ease of installation. End plate quickly connects to channel connector for continuous row alignment. Lampholder mounting brackets are easily inserted with snap-in action.

### B...Electrical\*

Ballast are CBM/ETL Class "P" and positively secured by mounting bolts. Metal clad lampholders are spring loaded for turret safety. UL listed. Add "CAN" prefix to catalog number for CSA certification.

### C...Finish

Multistage iron phosphate pre-treatment ensures maximum bonding and rust inhibitor. Lighting grade, baked white enamel finish.

### D...Reflectors

Die formed prime steel, code gauge. Formed edges for added strength. 12" width. Reflectors secured with quarter-turn fasteners. All reflectors 4" sections. Baked white enamel. Standard with 8% uplight (IA). Closed top reflector (IC). Optional industrial fixtures are available incorporating silver technology enhancements. (SilverLining)



## IA, IC240 232

4' OR 8' INDUSTRIAL  
2 LAMP  
Industrial

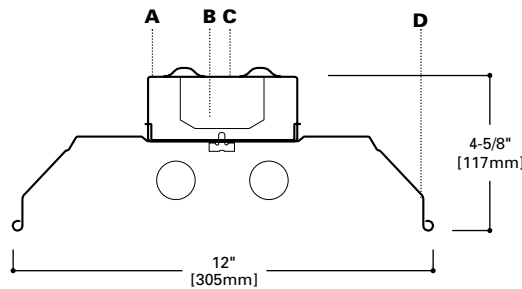

## LAMP CONFIGURATIONS

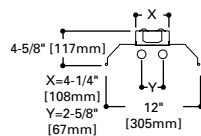

## MOUNTING DATA

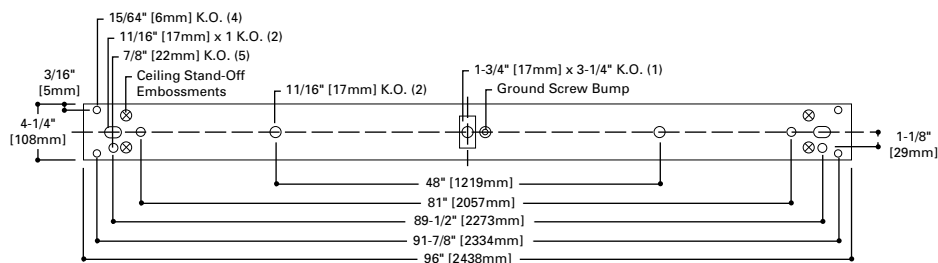
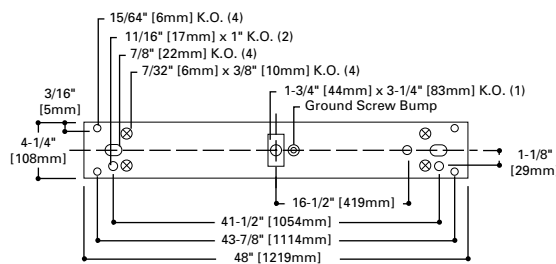

## ENERGY DATA

Input Watts:  
EB Ballast & STD Lamps  
240 (72)  
232 (61)

ES Ballast & STD Lamps  
240 (86)  
232 (71)

Luminaire Efficacy Rating  
LER = FI-79  
Catalog Number: IA-232

Yearly Cost of 1000 lumens,  
3000 hrs at .08 KWH = \$3.04

\*Reference the lamp/ballast data in the Technical Section for specific lamp/ballast requirements.

PHOTOMETRICS

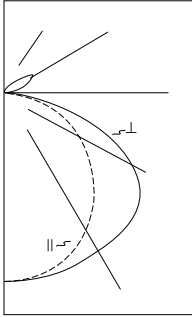

**IA-232**  
Energy Saving  
Ballast

FO32T8/31K Lamps  
2900 Lumens

Spacing criterion:  
(II) 1.3 x mounting  
height, (L) 1.5 x  
mounting height

Efficiency 89.0%

Test Report  
#ITL40397

LER = FI-79

Yearly Cost of 1000  
lumens, 3000 hrs at  
.08 KWH = \$3.04

**Coefficients of Utilization**

rc	Effective floor cavity reflectance																									
	80%				70%				50%				30%				10%				0%					
rw	70	50	30	10	70	50	30	10	50	30	10	50	30	10	50	30	10	50	30	10	50	30	10	0		
<b>RCR</b>	0	104	104	104	104	101	101	101	101	95	95	95	90	90	90	85	85	85	82	82	82	78	78	78	73	73
1	95	90	86	82	82	91	87	84	80	82	79	77	78	75	73	73	71	70	67	67	67	63	63	63	60	60
2	85	77	71	66	66	82	75	69	64	71	66	62	67	63	59	63	60	57	55	55	55	51	51	51	47	47
3	77	67	59	53	53	74	65	58	52	62	56	51	58	53	49	55	51	47	45	45	45	41	41	41	37	37
4	70	59	51	44	44	67	57	50	44	54	48	42	51	46	41	49	44	40	38	38	38	34	34	34	30	30
5	64	52	44	38	38	62	51	43	37	48	41	36	46	40	35	43	38	34	32	32	32	28	28	28	24	24
6	59	47	38	32	32	57	45	38	32	43	36	31	41	35	30	39	34	30	27	27	27	23	23	23	19	19
7	54	42	34	28	28	52	41	33	28	39	32	27	37	31	27	35	30	26	24	24	24	20	20	20	16	16
8	51	38	30	25	25	49	37	30	25	35	29	24	34	28	24	32	27	23	21	21	21	17	17	17	13	13
9	47	35	27	22	22	45	34	27	22	32	26	21	31	25	21	30	24	21	19	19	19	15	15	15	11	11
10	44	32	25	20	20	43	31	24	20	30	24	19	29	23	19	27	22	19	17	17	17	13	13	13	9	9

**Zonal Lumen Summary**

Zone	Lumens	%Lamp	%Fixture
0-30	1064	18.4	20.6
0-40	1800	31.0	34.9
0-60	3501	60.4	67.8
0-90	4774	82.3	92.4
90-180	390	6.7	7.6
0-180	5164	89.0	100.0

**Candela**

Angle	Along II	45°	Across L
0	1322	1322	1322
10	1307	1311	1315
20	1239	1267	1303
30	1127	1201	1292
40	981	1130	1285
50	800	1049	1226
60	595	926	1045
70	367	674	621
80	139	226	104
90	0	25	10
100	0	88	94
110	0	153	170
120	0	117	229
130	0	61	153
140	0	12	76
150	0	4	10
160	0	2	4
170	1	5	4
180	3	3	3

ORDERING INFORMATION

SAMPLE NUMBER: IA-232

			<b>2</b>				<b>Options</b> (add as suffix)
	Tandem 8T=8' Length	SS=SilverLining Reflector	Number of Lamps (Not included)	Voltage <sup>2</sup> 120=120V 277=277V	Ballast Type LE3= Energy Saving Ballast <sup>®</sup> LEOC8= Energy Saving Ballast (T-8 Lamp Only) EB = Generic Electronic Ballast No. of Ballasts 1 or 2 Lamp Size 2=T12 8=T8 <small>(For Specific Electronic Ballast Specify Brand and Catalog Number)</small>		Options GL=Internal Single Element Fusing GM=Dual Element Fusing EL4=Emergency Lighting self-contained <sup>2</sup> RIF1=Radio Interference Suppressor 6-3/18 SJT-C&P- 515P=Cord & Plug (120V) 6-3/18 SJT-C&P- L715P=Cord & Plug (277V) PI=Plug-In Option (Consult PI Option Catalog Page) TILW=Tandem In-Line Wiring Option (Consult TILW Option Catalog Page) POX=Porlux Finish <small>(Additional options available. See Accessory Section)</small>
	Series IA=Apertured Reflector IC=Closed Top Reflector ICW=Extra Wide Channel - Reference STW Series with Symmetric Reflector		Wattage (Length) 40=40W (48") 32=32W T8 (48")				

CAN=Add "CAN" prefix for CSA certification.

ACCESSORIES

(Order Separately)

A1B/Spacer-U=Spacer 1-1/2" to 2-1/2" from ceiling

(Use 2 per fixture)

GRP-SS=Gripper Hanger (Use 2 per fixture)

SCF=Fixed Stem Set (Specify Length)

SCS=Swivel Stem Set (Specify Length)

SCA=Adjustable 48" Stem Set

AYC-Chain/Set-U=Chain Hanger Set (Use 1 set per fixture)

WG/DI-4FT-U<sup>2</sup>=Wire Guard

CLC=Special Connector

(Additional Accessories Available. See Options and Accessories Section).

NOTE See option/accessories sections for additional detailed product data. Specifications and Dimensions subject to change without notice.

<sup>1</sup> Standard Ballast (Non-LE3).

<sup>2</sup> Contact Pre Sales Technical Support.

SHIPPING INFORMATION

Catalog No.	Wt.
IA-232	13 lbs.
8TIA-232	26 lbs.