

Type
Project
Catalog No.
Lamp/Wattage

**NTH-133LED**  
**Belgium™ Die-Cast Front Loading Gimbal**  
**with LED PAR38**  
 Lamp: 20W LED PAR38

**PRODUCT DESCRIPTION**

Line voltage front-loading gimbal fixture. Heavy die-cast construction provides superior strength, rigidity, and heat dissipation. Locking front ring protects lamp and enhances appearance. Front loading capability provides quick, easy lamp maintenance with minimal interference with original fixture aiming.

**FEATURES**

- Heavy die-cast construction
- Die-cast Lamp Locking Ring
- Fully adjustable, firm angle position
- High-strength stainless steel electrical contacts
- One or two circuit track capable
- Available in J-Style and L-Style

**CONSTRUCTION**

**Housing**

0.09" Die-cast aluminum two-piece housing with modernistic detail secured together with finished Allen-head screw. Two arms constructed from thick 0.050" die-cast aluminum extend from the housing and contain molds to secure 0.25" die-cast aluminum locking ring.

**Structural Arm**

0.10" "L" Steel bracket connects fixture housing to electrical contact head. Two finished plastic knobs allow user to lock fixture position to desired angles.

**Socket**

Porcelain jacketed aluminum screw thread medium-base socket.

**Wiring**

Teflon coated wire lead connects socket and housing to electrical contact head. Teflon coating is durable and resists heat degradation from lamp and housing radiation.

**Lamp**

See LED Lamp Chart below.

**Contact Head Assembly**

"H" Style (standard): Three 0.030 stainless steel contacts mounted in premium plastic housing.

"J" Style: Two contacts and ground contact mounted in premium plastic housing with on/off switch.

"L" Style: Two contacts and ground contact mounted in premium plastic housing.

**Finishes**

Black, Silver, or White heat-rated powercoat. Custom painting or anodizing for special applications are also available. Custom finishes will require lead times that vary depending on vendor schedule. Please consult factor for quotation, and provide either a Dunn Edwards number or color chip for exact matching.

**One/Two Circuit Conversion**

Positive contact (opposite neutral and ground contacts) is preset to "down" position at the factory, but may be raised to the high position to install onto the second circuit of Nora Lighting's NT-2300 series two-circuit track.

**DIMENSIONS**

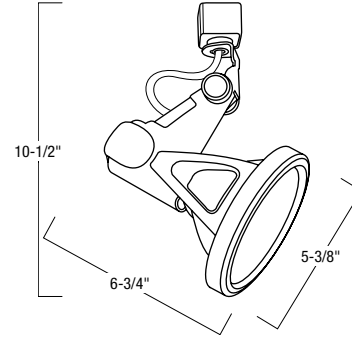

Length: 6-3/4"  
 Diameter: 5-3/8"  
 Max. Extension: 10-1/2"

**Compatibility**

Nora track heads are compatible with Halo or any other brands configured to Halo 3 wire track configuration. J-Style and L-Style track adapters are available.

*Note: Fixtures may not be compatible with non-Nora monopoint adapters.*

**Labels and Warranty**

cULus Listed as track lighting fitting



**LED Lamp Chart (Lamps are Energy Star and cULus Listed)**

ORDER SUFFIX	KELVIN	WATTS	LUMENS	BEAM ANGLE	CBCP	CRI	RATED LIFE	DIMMABLE
<b>LED PAR38</b>								
E80	2700	20	1000	15	8500	80	25K	Yes
E81	3000	20	1100	15	9000	80	25K	Yes
E82	2700	20	1000	25	3700	80	25K	Yes
E81	3000	20	1100	25	4000	80	25K	Yes
E80	2700	20	1000	40	1700	80	25K	Yes
E81	3000	20	1100	40	1800	80	25K	Yes

**Belgium™ Die-Cast Front Loading Gimbal with LED PAR38**

Belgium™ Die-Cast Front Loading Gimbal with LED - select one from each column

Catalog No.	Finish	LED Lamp	Contact Head
NTH-133	B = Black	E80 = LED PAR38	(Blank) = H-Style
	S = Silver	E81 = LED PAR38	/J = J-Style
	W = White	E82 = LED PAR38	/L = L-Style
		E83 = LED PAR38	
		E84 = LED PAR38	
		E85 = LED PAR38	