

NHP-2L Series

6" Vertical Economy New Construction Housing with Baffle Trim

Lamp: Dual 13W Magnetic 2-Pin Quad
Dual 13-26W Electronic 4-Pin Quad

PRODUCT DESCRIPTION

New construction six inch vertical compact fluorescent down light, for use with two quad lamps. Use in non insulated ceilings, where insulation can be kept 3" from fixture. A wide variety of finishing trims are available. Adheres to the minimum lumens to watts ratio that qualifies to Energy Star.

CONSTRUCTION

Mounting Frame

One piece .050 galvanized steel die cut frame.

Housing

0.040 steel housing adjusts from 5/8" (Min) to a maximum ceiling thickness of 1-5/8". Integral spring brackets remain flush with housing. When using trims with torsion trim spring, fold brackets inward 45° to accept torsion spring.

Socket Plate

Galvanized steel socket plate adjust inside housing for optimum light performance. Contains sockets to accept 2-Pin compact fluorescent lamps for use with magnetic ballasts or 4-Pin sockets if electronic ballast option is required.

Bar Hangers

Two 13-3/4" to 24" adjustable bar hangers with nails are included on frame. Bar hangers are parallel to junction box, but can be repositioned 90° perpendicular to junction box if desired. Bar hanger foot contoured to align to bottom of construction joist. A T-Bar notch allow for easy installation in a suspended ceiling.

Junction Box

Prewired 25 cubic inch .064" thick galvanized steel, with seven 1/2" knockout, four Romex® pryouts, and snap on covers. All leads are #18AWG wire, the ground wire is connected to the bottom, and quick connectors are supplied on all leads. Through branch circuit wiring, (4-in, 4-out).

Lamps

- Two 13W Magnetic 2-Pin Quad lamps ordered separately.
- 13-26W Electronic 4-Pin Quad lamps ordered separately.

BALLAST

Magnetic

Standard Class P 120V magnetic ballast in normal power factor.

Sound Rated: A
Starting Temperature: 32°F (0°C)
THD <10%

Electronic

Thermally protected, electronic high power factor, single tap input voltage ranging from 110V – 277V, 0.358 Ampere - 0.1552 Ampere, 50/60Hz with end of life protection. Class P, 13 Watts maximum.

Starting Temperature 0° F – 18°C
Operating Ambient Temperature 75°C (Max)
Start Rating >50,000
Power Factor HPF
Flicker <3%



Type _____
Project _____
Catalog No. _____
Lamp/Wattage _____

DIMENSIONS

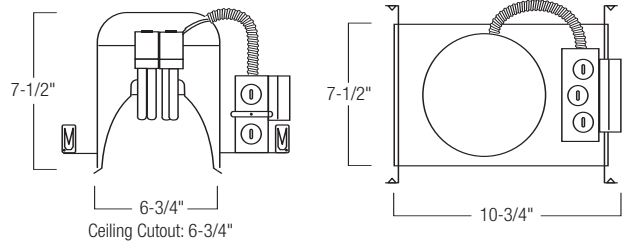

Cut out: 6-3/4"
Height: 7-1/2"

Housing Length: 10-3/4"
Housing Width: 7-1/2"

Trim

Precision spun 0.040 aluminum with deep groves to reduce aperture glare. Non-reflective matte black or white painted finishes.

Optional Dimming

A variety of dimming ballast option are available in 13-26W. Each option requires a controller that is compatible. Specify suffix.

- DAS Advance Mark X, AMBI Star 120V (2Wire), Residential
- D10 Universal Technologies 0-10V (4Wire),
- MX1 Advance Mark X 120V (2Wire), (Specify Wattage)
- MX2 Advance Mark X 277V (2Wire), (Specify Wattage)
- M7 Advance Mark 7 (4Wire),
- L51 Lutron SE 5% 120V (3Wire), (Specify Wattage & Voltage)
- L52 Lutron SE 5% 277V (3Wire). (Specify Wattage & Voltage)

Optional Emergency

Emergency back-up operates one lamp for a minimum of 90 minutes. Unit includes battery, charger and test plate with indicator light. Emergency ballasts are for dry locations.

For one lamp operation:

- Add: (EM) Emergency ballast 650 Lumen,
- (EM2) Emergency ballast up to 1300 Lumen.

Optional Accessories

- FS Fuse 2A
- NRA-28 27" Flat Bar Hanger

Labels and Listings

UL Listed for damp location w/ feed through
NY Approved: Calendar #43896
Energy Star Rated (Electronic ballast only)



Create a complete fixture/trim catalog number: Example: NHP-26/2LELEM / NTA-101/2PL

Housing - select one box from each column				Options			
Catalog No.	Lamps	Wattage	Ballast	Dimming		Emergency	Fuse
NHP-	2	13	EL	DAS	M7	EM	FS
		18	M	D10	L51	EM2	
		26		MX1	L52		
					MX2		

Baffle Trims			
Catalog No.	Baffle	Reflector	Ring
NTA-101/2PL	B	C	W
NTA-102/2PL	W		

Baffle Finishes: B = Black, W = White Reflector Specular Finishes: C = Chrome



BAFFLE TRIMS

NTA-101/2PL Cone Reflector w/Black Baffle Insert

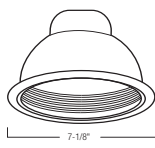
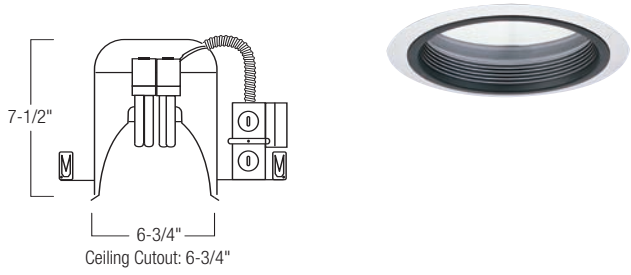

Baffle: Black (B),
Ring: 1/2"
Trim OD: 7-1/8"
Baffle Depth: 1"

NTA-102/2PL Cone Reflector w/White Baffle Insert

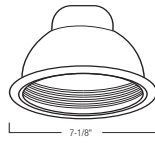
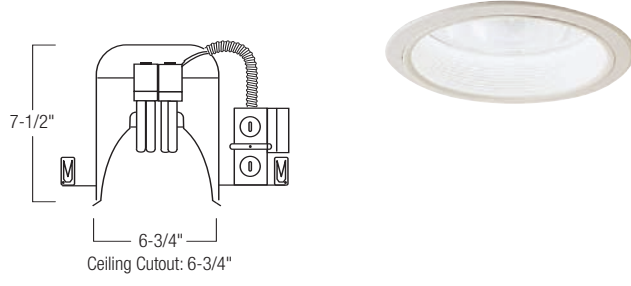

Baffle: White (W)
Ring: 1/2"
Trim OD: 7-1/8"
Baffle Depth: 1"