

NM-120/130 Series

3" Under Cabinet Halogen Fixtures



LAMP WATTAGE

- (1) Q20 G4
- (1) Q35MR11 (not included with fixture)
- (1) Q35MR16 (not included with fixture)

DESCRIPTION

Three - inch downlight rated for use with one G4, one MR11, or one MR16 in under cabinet applications.



FEATURES

- Diecast Aluminum Body (G4 Fixtures Only)
- Tempered Glass Shield
- High Quality Specular Finish
- Recessed or Surface Applications
- May be used with standard dimmers

MOUNTING

Mounting screws provided for G4 surface fixtures; NH housing required for recessed MR11 & MR16 fixtures.

ELECTRICAL SYSTEM

Lamp socket with fiberglass insulated wiring is provided with strain relief installed into the housing rear of G4 surface fixtures, and provided separately for direct attachment to MR11 or MR16 lamps. 18" (46cm) wire lead included. On NM126 kit, lead terminates at pre-installed quick-connect device for easy installation into plug-in transformer.

UL COMPLIANT

ETL listed to UL Standard 1571 and ANSI/UL 153 requirements. For use in indoor, dry location applications.

Note: NH housing is required with NM-129 and NM-130 fixtures.

TRANSFORMERS

Electronic, solid state low voltage transformers. Approved for remote applications. Contains short circuit and overload protection. Note: may be dimmed with standard incandescent dimming controls. UL/ETL recognized component. 300 watt transformer is fully UL listed and has six 50 watt class 2 fused circuits. Use of a 300 watt transformer is recommended for all commercial applications and any others requiring UL listing specifically on the transformer, or class 2 protection on the installation.

MULTI-TAP CONNECTORS

Modular wiring connector to connect 3, 4, or 6 fixtures to one (1) remote transformer. Accepts quick connects from fixture(s) and includes 18" (46cm) lead for connecting to remote transformer.

PRODUCT MATRIX

Ordering Example: **NM-130G / NH-121** - 35 Watt MR11, Recessed Halogen, Smooth Face, Gold Finish

Item No	Lamp	Description	Finish
NM-126	20G4	3-Lamp Kit w/ 60 Watt Transformer, Surface Halogen, Grooved Face	W, B, C, G
NM-127	20G4	Surface Halogen, Grooved Face	W, B, C, G
NM-128	20G4	Surface Halogen, Smooth Face	W, B, C, G
NM-129 / NH-120	35MR16	Recessed Halogen, Smooth Face	W, B, C, G
NM-130 / NH-121	35MR11	Recessed Halogen, Smooth Face	W, B, C, G

Specify Finish: (W) White; (B) Black; (C) Chrome; (G) Gold

DIMENSIONS

	A	B	C	D	E
NM-127	2-5/8" (67mm)	1-1/8" (29mm)	7/8" (23mm)	2-3/16" (56mm)	1/4" (7mm)
NM-128	2-5/8" (67mm)	1" (26mm)	7/8" (23mm)	2-3/16" (56mm)	1/8" (4mm)
NM-129	3-1/2" (89mm)	1-1/4" (32mm)	2-1/2" (64mm)	2-3/4"* (70mm)	4"* (104mm)
NM-130	2-17/32" (65mm)	1-3/4" (45mm)	1-3/4" (45mm)	2"* (52mm)	2-3/4"* (70mm)

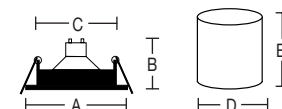
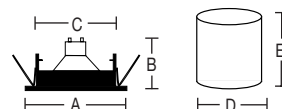
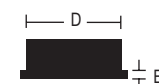
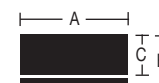

* Measurements of NH-120/NH-121 housing (not included). NH housing is required with NM-129 & NM-130 fixtures.

NM-120/130 Series *continued*

3" Under Cabinet Halogen Fixtures

TRANSFORMERS

6x50

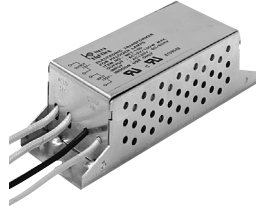
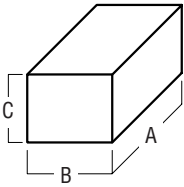

	60Watt NET-1060	75Watt NET-1075	105Watt NET-1105	150Watt NET-1150	6x50Watt N/A NET-300/C2	6x50Watt N/A NMT-300/C2
Blister Pack	NET-1060	NET-1075	NET-1105	NET-1150	N/A	N/A
Boxed	NET-2060	NET-2075	NET-2105	NET-2150	NET-300/C2	NMT-300/C2
A	3-1/8" (80 mm)	3-1/8" (80 mm)	5-1/8" (131 mm)	5-1/8" (131 mm)	7-5/8" (193 mm)	6-3/8" (162 mm)
B	1-7/8" (48 mm)	1-7/8" (48 mm)	1-3/4" (45 mm)	1-3/4" (45 mm)	3-1/2" (89 mm)	7" (178 mm)
C	3/4" (20 mm)	3/4" (20 mm)	1-3/8" (35 mm)	1-3/8" (35 mm)	1-5/8" (42 mm)	3-3/8" (86 mm)

COLOR FILTERS

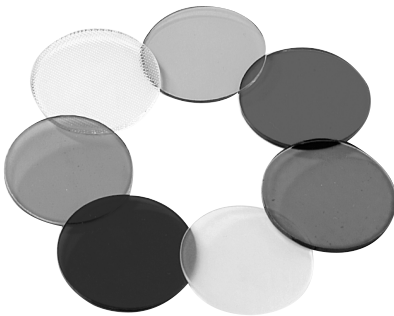

- NM-100B Blue
- NM-100Y Yellow
- NM-100G Green
- NM-100R Red
- NM-100F Frosted
- NM-100L Linear Spread
- NM-100S Standard Spread

Specify catalog number plus:
 /128 for G4 fixtures
 /MR11 for MR11 fixtures
 /MR16 for MR16 fixtures
 Example: NM100L/MR11

MR11/MR16 HOUSINGS



NH-120 Mini Housing for NM-129 MR16 Fixture



NH-121 Mini Housing for NM-130 MR11 Fixture