

HID FLOODS BRACKETS

Heavy duty Brackets support our heaviest floodlights.



Rigid, galvanized steel for secure floodlight mounting

Heavy duty polyester powder coated steel

Double Reinforced weld joints

Heavy Duty brackets for Heavy Duty Floods!



Specifications

BULLHORNS:

1, 2 or 3 tenons for slipfitters.
Bullhorns fit 2 3/8" (6cm) O.D. tenons and accommodate 2 3/8" (6cm) slipfitters.
Steel tubing .2" diameter, 150" & .200" thick welded with (4) 3/8" Bolts for securing to pole

Finish:

Weather resistant polyester powder, architectural bronze .
Galvanized brackets are primed and then hot dip galvanized.

Slipfitters & Wall Brackets:

3/16" thick steel with 1/2" nuts and bolts

Info Online 24/7

Spec Sheets & Installation Manuals
www.rabweb.com > click "PRODUCTS"



MAB Angle Bracket holds a MegaFlood for yard lighting

Slipfitter Bracket

Mounts to: 2 3/8" Tennon
 Accepts: Slipfitter:

Finish: ● Architectural Bronze



Catalog Numbers

BSF

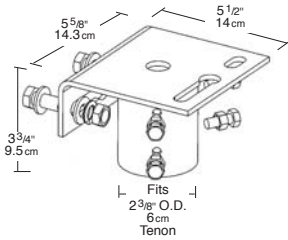

Wall Bracket

Mounts to: Wall
 Accepts: Trunnion
 Spacing: 9"

Finish: ● Architectural Bronze



BWALL9

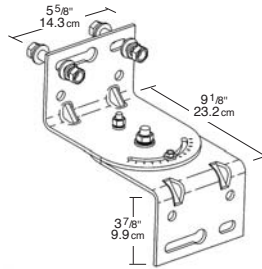

New!

Wood Curved Bracket

Mounts to: Wood Pole
 Accepts: Trunnion
 Spacing: 18"
 Max. Wt. Capacity: 105 lbs
 Max EPA: 5

Finish: ● Galvanized Steel



BWC18

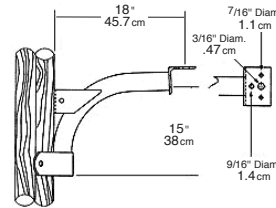

New!

Wood Curved Bracket

Mounts to: Wood Pole
 Accepts: Slipfitter
 Spacing: 12"
 Max. Wt. Capacity: 105 lbs
 Max EPA: 5

Finish: ● Galvanized Steel



BWC12

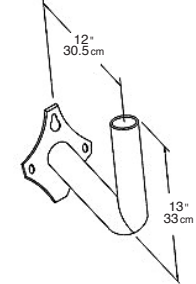

New!

Pole Adapter

Mounts to: Steel Pole
 Accepts: Slipfitter

Finish: ● Architectural Bronze



Catalog Numbers

BAD4 Mounts to 4" Square Pole
 BAD5 Mounts to 5" Square Pole
 BAD6 Mounts to 6" Square Pole
 BAD8 Mounts to 8" Square Pole

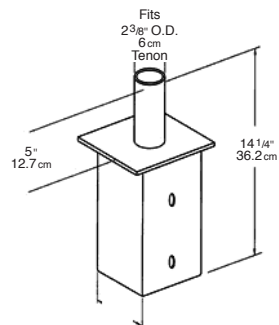

New!

Cross Arm Bracket

Mounts to: BSF, BWALL9, BWC18 & BWT12
 Accepts: 2 Trunnions
 Spacing: 28"
 Max. Wt. Capacity: 52 lbs/fixture
 Max EPA: 5

Finish: ● Architectural Bronze



BCAT2

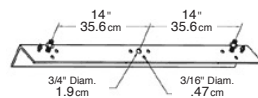

New!

Trunnion Wall Bracket

Mounts to: Wall
 Accepts: Trunnion
 Spacing: 12"
 Max. Wt. Capacity: 105 lbs
 Max EPA: 5

Finish: ● Galvanized Steel



BTW12

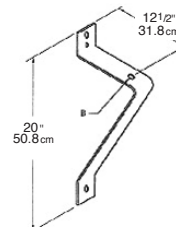

New!

Slipfitter "S" Bracket

Mounts to: Wood Pole
 Accepts: Slipfitter
 Spacing: 7"
 Max. Wt. Capacity: 105 lbs
 Max EPA: 5

Finish: ● Galvanized Steel



BWS7

