



nCM 6



HIGH BAY 360° SENSOR CEILING MOUNT • LOW VOLTAGE • PASSIVE INFRARED (PIR)

SPECIFICATIONS

FEATURES

- PIR Occupancy Detection
- 360° Coverage
- Communicates w/ nLight Network
- Integrated On/Off Photocell
- Remotely Configurable/Upgradeable
- Push-Button Programmable
- Adjustable Time Delay
- 100 Hr Lamp Burn-in Timer
- Green LED Indicator

PHYSICAL SPECS

- SIZE: Circular 4.55" Dia. (11.56 cm)
- 1.55" Deep (3.94 cm)
- WEIGHT: 6 oz
- MOUNTING:
 - Ceiling Tile Surface
 - Round Fixture Box
 - Single Gang Handy Box
- COLOR: White
- NETWORK CONNECTION:
 - 2 RJ-45 Ports

ELECTRICAL SPECS

- POWER CONSUMPTION: < 2 mA
- DIMMING LOAD:
 - Sinks < 20mA;
 - ~40 Ballasts @ .5mA each
- WIRES: None

ENVIRONMENTAL SPECS

- OPERATING TEMP:
 - 14° to 160° F (-10° to 71° C)
- RELATIVE HUMIDITY:
 - 20 to 90% non-condensing

OTHER

- UL and CUL Listed
- Title 24 Compliant
- 5 Year Warranty
- Assembled in the U.S.A.

Designed for mounting heights of up to 45 ft (13.72 m), the nLight nCM 6 Series High Bay 360° occupancy sensor has a 15-20 ft (4.57- 6.1 m) radial coverage pattern that overlaps the area lit by a typical high bay fixture. Applications include: warehouses, racquetball courts, and gymnasiums. Multiple fixture control is best handled by one or more nCM 6 sensors and an nPP16 power pack, while individual fixture control is best handled by the nCMR 6 Series line voltage version sensor. These sensors are ideal for on/off control of T5/T8 fluorescent lighting. HID bi-level fixtures can also be controlled when the Start-to-High feature is enabled via SensorView software.

SENSOR OPERATION

The sensor indicates occupancy when changes in the infrared energy within its field-of-view are detected. A relay located elsewhere within the sensor's zone is then signaled to switch the line voltage lighting load on. An internal time delay, factory set at 10 minutes, keeps the sensor in the occupancy state during brief periods of no activity. The timer is adjustable, and is reset every time occupancy is re-detected. This state-of-the-art sensor requires no field calibration or adjustment.

ON/OFF PHOTOCELL OPERATION

As a standard feature, these sensor have an integrated on/off photocell. This photocell can provide two types of operation. The first mode provides increased energy savings by switching lights off during occupied periods with sufficient daylight contribution. The second mode will prevent lights from initially turning on if adequate daylight is present, but won't switch them off once the lights are on. All photocell operation is disabled by default.

NLIGHT OPERATION

This sensor is nLight-enabled, meaning it has the ability to communicate over an nLight network. When daisy-chain wired, using CAT-5 cabling, with other nLight-enabled sensors, power packs, or WallPods, an nLight control zone is created. Once linked to a Gateway, directly or via a Bridge, the zone becomes capable of remote status monitoring and control via SensorView software.

MASKING KIT

The sensor views a 360° circular pattern. The kit provided may be used to mask off half of the viewing for the end of the aisle, or trim the side viewing to create a rectangular pattern for the center of the aisle. Shown below is the masking for the center of the aisle and the end of the aisle.

OPTIONS

AUTOMATIC DIMMING CONTROL PHOTOCELL (ADCX / ADC)

- Photocell within sensor maintains total room light level by automatically adjusting controlled lighting
- Typically used with remote nLight devices with dimming outputs (e.g. nIO LED, nSP5 D, nSP5 PCD, nEPP5 D, nPANEL 4)
- Provides a second time-out period that enable the lights to go to a dim setting before turning off
- Follows dimming commands from nLight WallPod dimmer or SensorView software
- ADC version adds 20 AWG violet (dim output) and gray (common) wires, & an 18 AWG green ground wire

LOW TEMP/HIGH HUMIDITY (LT)

- Sensor electronics are coated for corrosion resistance
- Operates down to -40° F/C
- Required for cooler/freezer applications

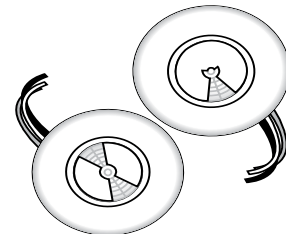

ORDERING INFO

nCM 6 [DAYLIGHTING] [TEMP/HUMIDITY]

OPTIONS	DAYLIGHTING	TEMP/HUMIDITY
	Blank = None ADCX = Auto Dimming Control Photocell (no wires) ADC = Auto Dimming Control Photocell (with 0-10 VDC wires)	Blank = Standard LT = Low Temp

WIRING (DO NOT WIRE HOT)

T568B pin/pair assignment is recommended for all CAT-5e cables. Sensor power is provided via the CAT-5e connection to an nLight power pack/supply, nLight-enabled digital luminaire, or nLight Bridge.

nCM 6 & nCM 6 ADCX

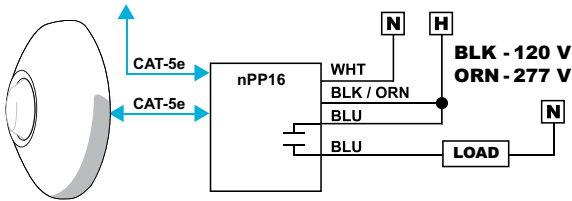

nCM 6 ADC

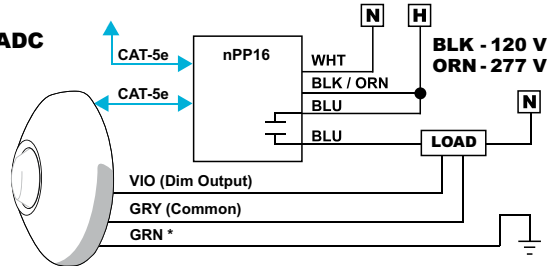

*Note: A green wire is available for an optional connection to an approved ground. This wire is isolated from the class 2 circuitry of the sensor. Connection will provide improved network protection in case of accidental landing of line voltage to VIOLET or GRAY dimming wires. If an approved ground is not available the green wire should be capped.

COVERAGE PATTERN

HIGH BAY 360° LENS

- Best choice for 15 to 45 ft (4.57 to 13.72 m) mounting heights
- 15 to 20 ft (4.57 to 6.1 m) radial coverage overlaps area lit by a typical high bay fixture
- Large Motion (e.g. walking) detection up to a 35 ft (10.67 m) mounting height
- Extra Large Motion (e.g. forklifts) detection up to a 45 ft (13.72 m) mounting height

LOW VIEW

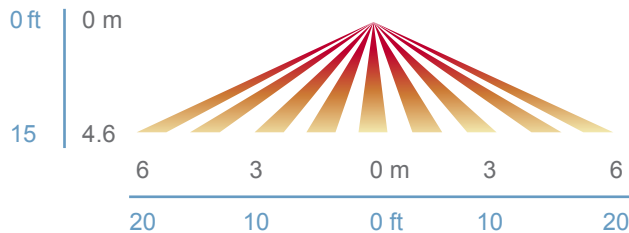

HIGH VIEW

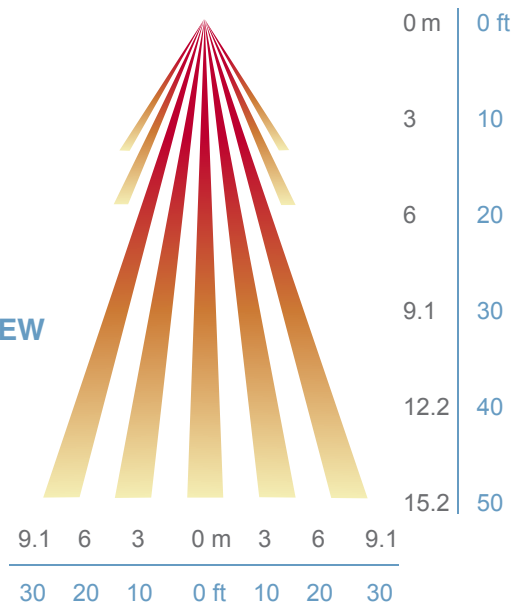

INSTALLATION

MOUNTING

- For mounting sensor directly to a ceiling tile or a metallic grid, two self-tapping screws are provided
- Sensor's mounting holes also align with standard round fixture or single gang handy box (screws not provided)
- Sensor will detect motions crossing segments more effectively than motions parallel to beams
- For optimal detection, position sensor such that segments are crossed upon entrance and unable to view outside the space

PROGRAMMING

Refer to included instruction card for default settings and directions on programming the sensor via the push-button.

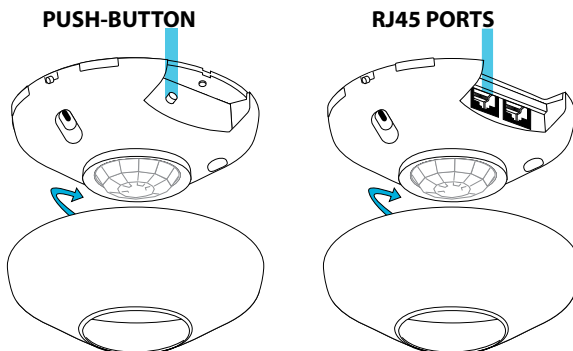

WARRANTY: Sensor Switch warrants these products to be free of defects in manufacture and workmanship for a period of 60 months. Sensor Switch, upon prompt notice of such defect, will, at its option, provide a Returned Material Authorization number and repair or replace returned product.
LIMITATIONS AND EXCLUSIONS: This Warranty is in full lieu of all other representation and expressed and implied warranties (including the implied warranties of merchantability and fitness for use) and under no circumstances shall Sensor Switch be liable for any incidental or consequential property damages or losses.