



# nCM-PDT



## STANDARD RANGE 360° SENSOR CEILING MOUNT • LOW VOLTAGE • DUAL TECHNOLOGY (PDT)

### SPECIFICATIONS

#### FEATURES

- Patented Dual Technology with PIR / Microphonics Detection
- 360° Coverage
- Communicates w/ nLight Network
- Remotely Configurable/Upgradeable
- Push-Button Programmable
- Adjustable Time Delay
- 100 Hr Lamp Burn-in Timer
- Green LED Indicator

#### PHYSICAL SPECS

SIZE 4.55" Dia. (11.56 cm)  
1.55" Deep (3.94 cm)

WEIGHT 6 oz

#### MOUNTING

- Ceiling Tile Surface
- Round Fixture Box
- Single Gang Handy Box

COLOR White

#### NETWORK CONNECTION

2 RJ-45 Ports

#### ELECTRICAL SPECS

POWER CONSUMPTION < 2 mA

#### DIMMING LOAD

- Sinks < 20mA;
- ~40 Ballasts @ .5mA each

WIRES None

#### ENVIRONMENTAL SPECS

##### OPERATING TEMP

14° to 160° F (-10° to 71° C)

##### STORAGE TEMP

-14° to 160° F (-26° to 71° C)

##### RELATIVE HUMIDITY

20 to 90% non-condensing

#### OTHER

- UL and CUL Listed
- Title 24 Compliant
- 5 Year Warranty
- Made in the U.S.A.

Open area office lighting control is made cost effective with the use of the nCM-PDT Series Standard Range 360° occupancy sensor. This small, yet powerful sensor provides line of sight PIR detection of small motion in a circular pattern and combines overlapping Microphonics™ coverage for detection of occupants working in their cubical space. By installing multiple nCM-PDTs on 30 ft (9.14 m) centers, large zones are created (typically one per circuit of lighting). The lighting is then controlled in blocks similar to manual switching. Restrooms with stalls, large storage areas with shelving, and libraries with study carrels are also easily and cost effectively controlled by the nCM-PDT.

#### SENSOR OPERATION

The sensor has Passive Dual Technology (PDT) which first sees motion using Passive Infrared (PIR) and then engages Microphonics™ to hear sounds that indicate continued occupancy. This patented technology uses Automatic Gain Control (AGC) to dynamically self adapt the sensor to its environment by filtering out constant background noise and detecting only noises typical of human activity. Once occupancy is detected, a relay located elsewhere within the sensor's zone is signaled to switch the line voltage lighting load on. An internal time delay, factory set at 10 minutes, keeps the sensor in the occupancy state during brief periods of no activity. The timer is adjustable, and is reset every time occupancy is re-detected. This state-of-the-art sensor requires no field calibration or adjustment.

#### NLIGHT OPERATION

This sensor is nLight-enabled, meaning it has the ability to communicate over an nLight network. When daisy-chain wired, using CAT-5 cabling, with other nLight-enabled sensors, power packs, or WallPods, an nLight control zone is created. Once linked to a Gateway, directly or via a Bridge, the zone becomes capable of remote status monitoring and control via SensorView software.

### OPTIONS

#### DIMMING CONTROL (-D)

- Provides dimming outputs to control 0-10 VDC dimmable ballasts
- Follows dimming commands from nLight Wallpod dimmer or SensorView software
- Adds 20 AWG violet & gray wires

#### ON/OFF PHOTOCELL (-P)

- On/Off Operation: Full control during periods of occupancy with adequate daylight
- Inhibit Operation: Prevents lights from turning on if adequate daylight is available

#### AUTOMATIC DIMMING CONTROL PHOTOCELL (-ADC)

- Photocell within sensor maintains total room light level by controlling levels of 0-10 VDC dimmable ballasts
- Provides a second time-out period that enable the lights to go to a dim setting before turning off
- Follows dimming commands from nLight WallPod dimmer or SensorView software
- Adds 20 AWG violet & gray wires

#### LOW TEMP/HIGH HUMIDITY (-LT)

- Sensor is corrosion resistant to moisture
- Operates down to -4° F/ 20° C

### ORDERING INFO

#### nCM-PDT-[DIMMING]-[DAYLIGHTING]-[TEMP/HUMIDITY]

OPTIONS

##### DIMMING\*

Blank = None  
-D = Dimming

##### DAYLIGHTING

Blank = None  
-P = On/Off Photocell  
-ADC = Auto Dimming Control Photocell  
-P-ADC = On/Off & Dimming Photocell

##### TEMP/HUMIDITY

Blank = Standard  
-LT = Low Temp

\*-D functionality also in -ADC option

## WIRING (DO NOT WIRE HOT)

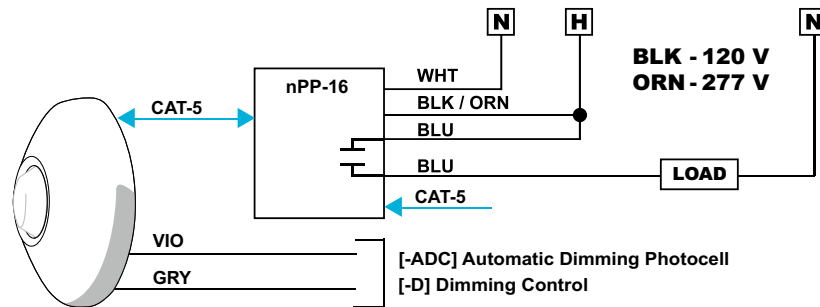

## COVERAGE PATTERN

### 9 STANDARD RANGE 360° LENS WITH MICROPHONICS™

- Best choice for small motion (e.g. hand movements) detection
- Viewing angle of 56° in a 360° conical shaped pattern
- Provides 12 ft (3.66 m) radial coverage when mounted to standard 9 ft (2.74 m) ceiling
- 8 to 15 ft (2.44 to 4.57 m) mounting heights provide 10 to 20 ft (3.05 to 6.10 m) radial coverage
- Microphonics™ detects normal human activity up to 20 ft (6.10 m), but will detect greater distances in spaces with hard floors or very quiet rooms with little or no background noise.

### SIDE VIEW

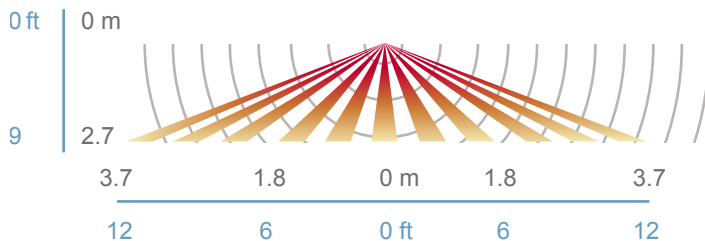

### TOP VIEW

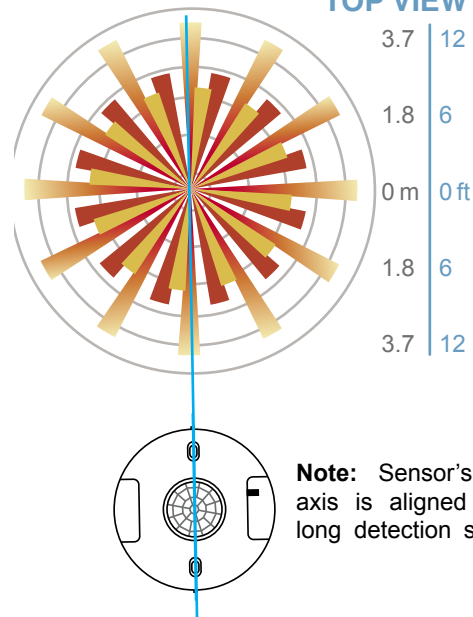

**Note:** Sensor's screw axis is aligned with a long detection segment

## INSTALLATION

- Mount sensor directly to a ceiling tile or a metallic grid (two self-tapping screws provided)
- Sensor's mounting holes also align with standard round fixture or single gang handy box (screws not provided)
- Interconnect unit (via RJ-45 ports) with other nLight devices in lighting zone using CAT-5 cables
- Once power is received via CAT-5 connection, all devices in zone will automatically begin functioning together according to each device's defaults
- Sensor will detect motions crossing segments more effectively than motions parallel to beams
- For optimal detection, position sensor such that segments are crossed upon entrance and unable to view outside the space

### PROGRAMMING

Refer to included instruction card for default settings and directions on programming the sensor via the push-button.

### PUSH-BUTTON

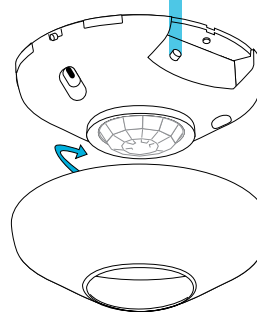

### RJ45 PORTS

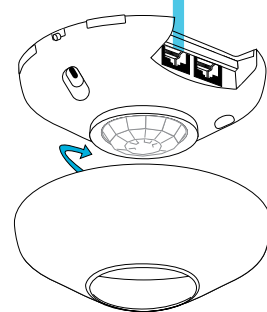

**sensorswitch**

**WARRANTY:** Sensor Switch, Inc. warrants these products to be free of defects in manufacture and workmanship for a period of 60 months. Sensor Switch, Inc., upon prompt notice of such defect, will, at its option, provide a Returned Material Authorization number and repair or replace returned product.

**LIMITATIONS AND EXCLUSIONS:** This Warranty is in full lieu of all other representation and expressed and implied warranties (including the implied warranties of merchantability and fitness for use) and under no circumstances shall Sensor Switch, Inc. be liable for any incidental or consequential property damages or losses.

**TN-101-01**