

## High Bay Multi-Bay 14" Series

### ORDERING INFORMATION

Catalog Number: Example: MBH14400MAJ-1

MBH					
<b>FIXTURE</b>	<b>REFLECTOR SIZE</b>	<b>WATTAGE</b>	<b>LAMP SOURCE</b>	<b>OPTIONS</b>	<b>VOLTAGE</b>
<b>MBH-</b> Open High Bay	<b>14-14"</b>	<b>150-150W</b>	<b>MA-Metal Halide</b> (HPF-CWA)*	<b>A-Hot/Cold start</b>	<b>1-120V</b>
<b>MBE-</b> Enclosed High Bay		<b>175-175W</b>	<b>LX-High Pressure</b> Sodium (HPF-CWA)	<b>B-Hot/Cold start</b>	<b>2-208V</b>
<b>MBS-</b> Enclosed unit without dustcover		<b>200-200W</b>	<b>LR-Linear Reactor</b> pulse start Metal Halide 277V only*	<b>C-Switch-on</b> auxiliary	<b>3-240V</b>
		<b>250-250W</b>	<b>PMA-Super</b> constant wattage auto regulated pulse start Metal Halide*	<b>D-Switch-on</b> auxiliary	<b>4-277V</b>
		<b>320-320W</b>		<b>F-Fusing</b>	<b>5-480V</b>
		<b>350-350W</b>		<b>G-Fusing</b>	<b>8-120V</b>
		<b>400-400W</b>		<b>J-Wiring</b>	<b>208V</b>
		<b>450-450W</b>		<b>K-Wiring</b>	<b>240V</b>
				<b>Z-Bi-Level</b>	<b>277V</b>
				<b>OR-Open rated</b>	

\*Requires open-rated lamp or enclosed optics.

### TECHNICAL INFORMATION

Multi-Bay High Bays use mogul base clear lamps. Lamps available but not supplied with fixture. High Pressure Sodium 150W units use E23-1/2 or BT25, 250W and 400W units use E18. Metal Halide 175W units use E28 or BT28, 250W and 400W units use E37 or BT37. 400W MH may also use E18. For open air applications only up to 55° Celsius ambient.

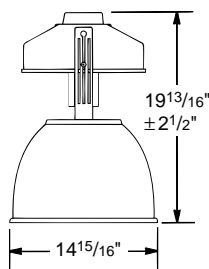
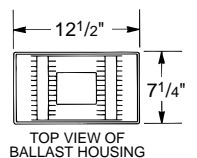

### OPTION DETAILS

- A**-Hot and cold start auxiliary external 150W medium base PAR lampholder, used until HID lamp reaches 70% of brightness.
- B**-Hot and cold start auxiliary interior 250W Bayonet base, used until HID lamp reaches 70% of brightness.
- C**-Switch-on auxiliary external 150W medium base PAR lampholder operating from secondary 120V source when HID circuit is "knocked out" by momentary voltage drop.
- D**-Switch-on auxiliary interior 150W DC Bayonet base, operating from secondary 120V source when HID circuit is "knocked out" by momentary voltage drop.
- F**-Heavy duty fuse in external holder for 120V, 277V, single
- G**-Heavy duty fuse in external holder for 208V, 240V, 480V, double
- J**-3' 3-conductor approved cable (14-3) with 15 amp Twist plug with proper NEMA configuration, includes open-loop hook.
- K**-3' 3-conductor approved cable (14-3) with 20 amp Twist plug with proper NEMA configuration, includes open-loop hook.
- Z**-Bi-Level high/low switching of HID lamps for maximum energy savings.

Accessories - See page 4-A



### PRODUCT SPECIFICATIONS

- High Bay fixtures are ideal for indoor applications where ceiling mounting heights exceed 15 feet. Typical applications include warehouse facilities, assembly areas, gyms, hangers, transportation garages, loading and staging areas.
- Universal light-weight, easy to handle die-cast aluminum ballast housing finished in Duraplex II gray polyester powder.
- Unique ballast housing design permits full flow-through ventilation for maximum cooling of all components.
- Heavy-gauge diffuse anodized aluminum reflector locks on adjustable straps for field adjustment of optics from wide to narrow distribution.
- Enclosed units use a formed dust cap to protect lamp and reflector from dust and grime.
- Enclosed units contain a clear heat-tempered glass lens retained by stainless steel spring clamps and safety cable.
- Rugged die-cast mounting plate tapped 3/4"-14 NPS, accepts 3/4" pipe or 714S, 715NEW, and 725S hooks.
- Unit slips onto mounting plate leaving both hands free for wiring.



UL Damp Location Listed.  
UL File Number: E86021

Available from [www.GoodMart.com](http://www.GoodMart.com)

## PHOTOMETRICS

See page 4-C for complete CU tables

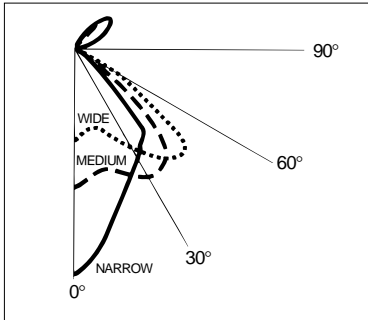

**MBE14250MA**  
Lamp: 250W Metal Halide, Clear  
Lumens: 20,500  
Report #'s ST92042, ST92043,  
ST92044

CANDLEPOWER DISTRIBUTION			
Deg.	Reflector Settings:		
	Wide	Medium	Narrow
0	2896	4306	7805
5	2767	4124	7270
15	2624	3864	5736
25	3197	4327	4688
35	4152	4593	3872
45	4787	3769	1931
55	2759	1376	841
65	1105	554	361
75	364	188	137
85	56	32	33
90	6	7	21
95	10	55	126
105	16	42	158
115	24	49	386
125	24	123	1178
135	92	676	1596
145	342	799	824
155	96	88	104
165	7	5	8
175	4	3	7
180	3	2	5

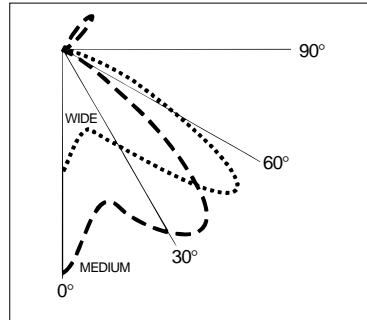

**MBH14400MA**  
Lamp: 400W Metal Halide, Clear  
Lumens: 36,000  
Report #'s ST91141, ST91143

CANDLEPOWER DISTRIBUTION		
Deg.	Reflector Settings:	
	Wide	Medium
0	5622	10303
5	4761	8877
15	3820	7256
25	4509	8831
35	6207	10125
45	8930	8079
55	8677	2553
65	3402	878
75	1007	277
85	142	39
90	4	12
95	25	91
105	46	74
115	31	66
125	29	176
135	42	1095
145	209	2039
155	512	479
165	4	6
175	6	3
180	7	3

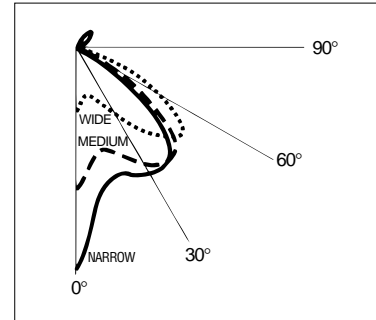

**MBH14400LX**  
Lamp: 400W H.P. Sodium, Clear  
Lumens: 50,000  
Report #'s ST91136, ST91137, ST91138

CANDLEPOWER DISTRIBUTION			
Deg.	Reflector Settings:		
	Wide	Medium	Narrow
0	5956	12999	20565
5	4845	10818	16103
15	4262	9245	12323
25	5769	10875	12689
35	8150	12447	13176
45	11221	11760	10737
55	10483	6466	4457
65	5433	2091	1395
75	1709	590	409
85	240	83	61
90			17
95	2	88	181
105	8	58	146
115	24	134	663
125	32	675	1314
135	100	1344	1923
145	388	1068	1419
155	176	237	244
165	2	4	3
175	2	4	4
180	1	4	3

## SUGGESTED SPECIFICATIONS

Fixture shall be indoor heavy-duty luminaire, HID fixtures shall include integral constant wattage high power factor autotransformer ballast (specify voltage, wattage, source) securely clamped in die-cast aluminum housing. Capacitors are nested within integral "outboard" pods. Vented "air-flow" construction isolates heat-sensitive capacitors from heat-generating core.

Fixture shall be equipped with deluxe glazed porcelain socket with nickel plated vibration proof "lamp-grip" socket and

spring-loaded center contact. Socket in H.P. Sodium units shall be pulse-rated at 4KV.

Fixture shall be supplied with 14" rigid heavy-gauge diffuse anodized aluminum reflector for use with clear lamps. Reflector locks on adjustable straps slotted with cast-in numbered positions for field-choice of proper reflector position for maximum lighting efficiency. Reflector positioning is labeled to outside of reflector.

Enclosed fixtures shall be supplied with

formed aluminum dust cap adjusts for varying reflector positions and protects lamp and reflector from dust and grime. Redirects up-light downward. Clear heat-tempered glass lens (enclosed units) cushioned in gasketed frame. Retained by stainless spring-clamps and safety bead-chain. (Specify optional features desired.)

Fixtures shall be UL-listed as "suitable for damp locations".

Fixture shall be Stonco Cat. No. (specify) with reflector set in position no. (specify).