



IN-WALL SPRING WOUND INTERVAL TIME SWITCHES

Automatically turns off load at end of timed cycle

**COMMERCIAL/
INDUSTRIAL**
with Metal Wallplate
Included



**FITS DECORATOR
OR STANDARD
SWITCHPLATE**
(not supplied)
Ideal for multi-gang
installations.



APPLICATIONS

- To control
- Ventilating Fans
 - Heat Lamps
 - Lighting
 - Appliances
 - Thermostats

Convenient for installation in hotels, motels, hospitals, schools, offices, industrial plants, private homes.

INSTALLATION

Fits 1-1/2 inch wall box or deeper. Installs as easily as a common wall switch.

For outdoor installation, use a NEMA 3R enclosure.

SPECIFICATIONS

Unit is mechanically spring wound, requiring no electricity to operate. Switch contacts are made when knob is rotated and break circuit at the end of a timed cycle, thereby turning OFF load (N.O. contacts).

Models with "hold" feature allow switch contacts to remain closed for constant ON of load.

Shaft is centered on the face of unit.

A wire strip gauge is provided on the back of each unit.

- Contact Ratings:** SPST 50/60 Hz
- 20 AMP inductive/resistive @ 125 VAC
 - 10 AMP inductive/resistive @ 277 VAC
 - 7 AMP Tungsten 125 VAC
 - 1 HP 125 VAC
 - 2 HP 250 VAC

Operating Temperature Range: 32° - 122°F (0° - 50°C)

Humidity: 0% - 90% RH (non-condensing)

Caution: This timer is not to be used in precision timing applications where inaccurate timing could have dangerous consequences (i.e., sun lamp, sauna, etc.)

ORDERING INFORMATION

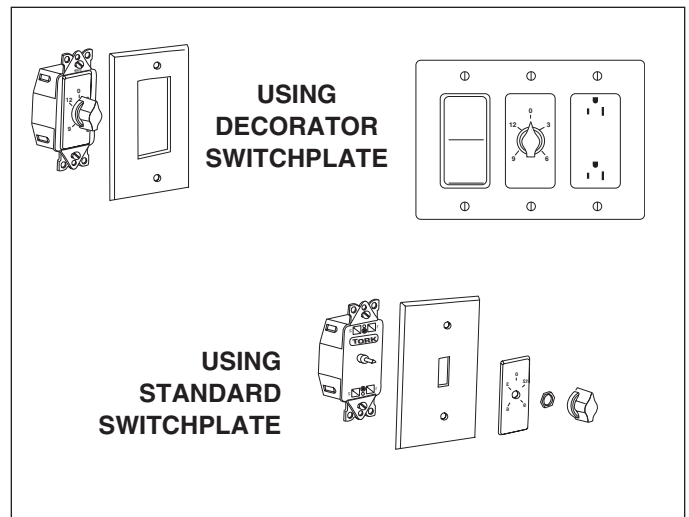

SPECIFICATION WRITER'S GUIDE

Furnish and install where indicated a mechanical spring wound timer which requires no electricity to operate the timing mechanism. Unit shall be supplied with shaft in center. Device must be capable of fitting a standard 1 1/2 inch deep wall box (for A500 series and accept a rectangular decorator wallplate or standard toggle switch plate or (for C500 series include a metal wallplate) be easily mountable on a panel board. Switch contacts shall break current carrying contacts at the end of timed cycles. Various timed cycles shall be available for up to 12 hours, with or without "HOLD" feature for constant ON. Timer shall be TORK Model A5_ _ _ (to fit requirement).

TIME CYCLE	METAL WALLPLATE		IVORY FACEPLATE		WHITE FACEPLATE	
	MODEL NUMBER WITH HOLD	MODEL NUMBER WITHOUT HOLD	MODEL NUMBER WITH HOLD	MODEL NUMBER WITHOUT HOLD	MODEL NUMBER WITH HOLD	MODEL NUMBER WITHOUT HOLD
5 Minutes	N/A	C505M	N/A	A505M	N/A	A505MW
0-15 Minutes	C515MH	C515M	A515MH	A515M	A515MHW	A515MW
0-30 Minutes	C530MH	C530M	A530MH	A530M	A530MHW	A530M W
0-60 Minutes	C560MH	C560M	A560MH	A560M	A560MHW	A560MW
0-2 Hours	N/A	C502H	A502HH	A502H	A502HHW	A502HW
0-4 Hours	N/A	C504H	A504HH	A504H	A504HHW	A504HW
0-6 Hours	C506HH	C506H	A506HH	A506H	A506HHW	A506HW
0-12 Hours	C512HH	C512H	A512HH	A512H	A512HHW	A512HW